

#6/2015/Art.-Nr.: 16454

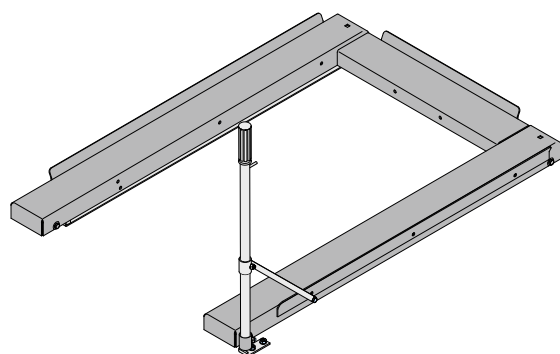

#33195 - 800 kg
#33196 - 1000 kg

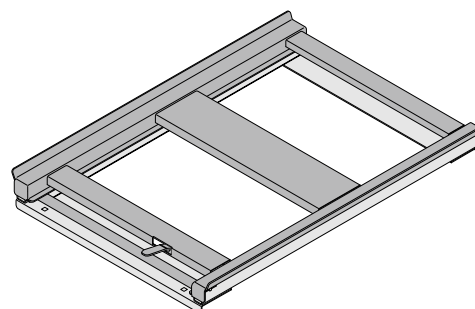

#33200 - 600 kg
#33201 - 800 kg

Aufbau- und Bedienanleitung (DE)
Instructions for assembly and use (GB)
Instructions de montage et d'utilisation (FR)
Richtlijnen en montagehandleiding (BE)
Instrucciones de montaje y manejo (ES)
Istruzioni per il montaggio e l'impiego (IT)
Montage- op betjeningsvejledning (DK)
összeállítási és kezelési útmutató (HU)
Instrukcja montażu i użytkowania (PL)
Návod k montáži a obsluze (CZ)
Návod na montáž a použitie (SK)
Інструкція по монтажу та експлуатації (UA)
Инструкция по сборке и использованию (RU)



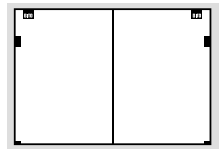

i BGR 234

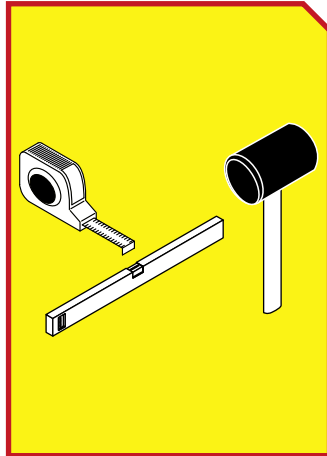

A

3 - 7

#33195 - 800 kg

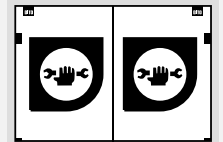
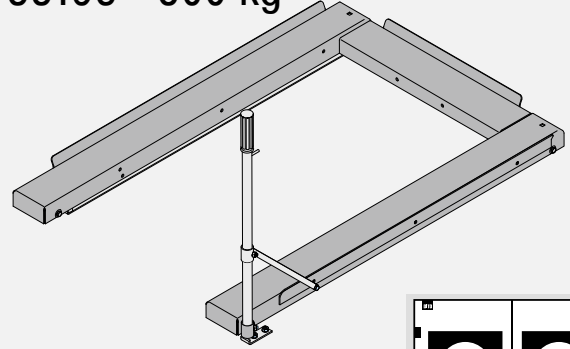

**8 - 13,
19**

#33196 - 1000 kg

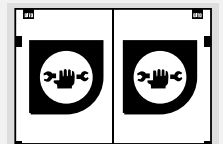
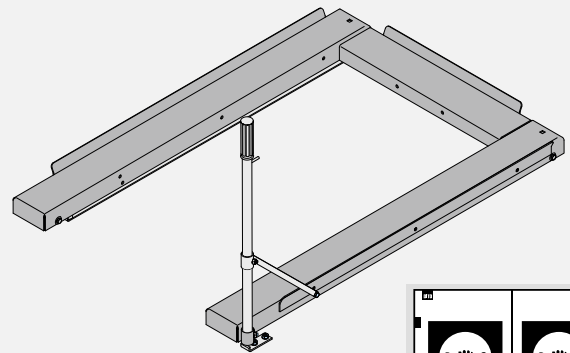

14 - 19

#33200 - 600 kg

#33201 - 800 kg

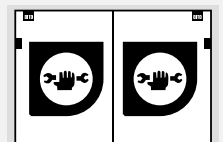
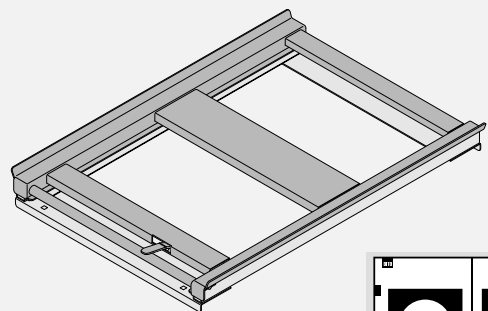

20 - 25



i BGR 234

!

DIN EN 15620
DIN EN 15635
DIN EN 15629

i **!** **!** **1** **!**

i

Ø 8,0,10,0 mm

8, 10

4 - 5 Nm

i Nm

M6-8.8	8 Nm
M8-8.8	22 Nm
M10-8.8	45 Nm
M10-10.9	70 Nm
M12-8.8	70 Nm
M12-10.9	110 Nm

i Nm

QR-Code

QR-Code

QR-Code App

<http://bito.com>

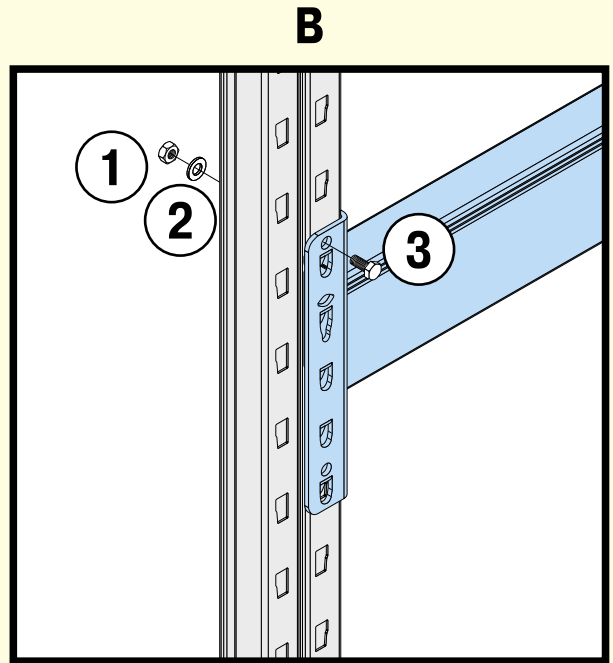
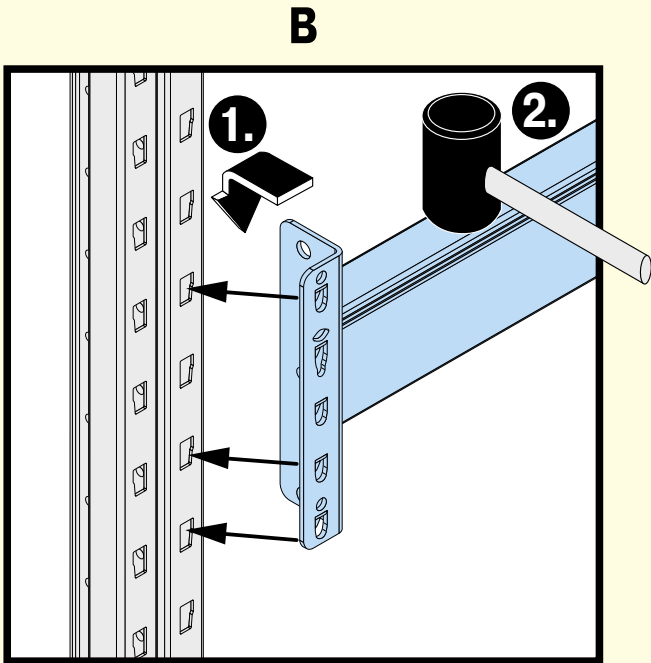
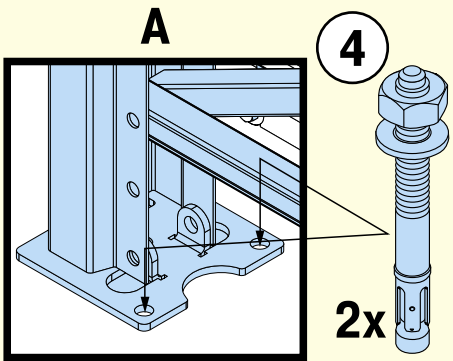

M6-8.8	8 Nm	
M8-8.8	22 Nm	
M10-8.8	45 Nm	
M10-10.9	70 Nm	
M12-8.8	70 Nm	
M12-10.9	110 Nm	

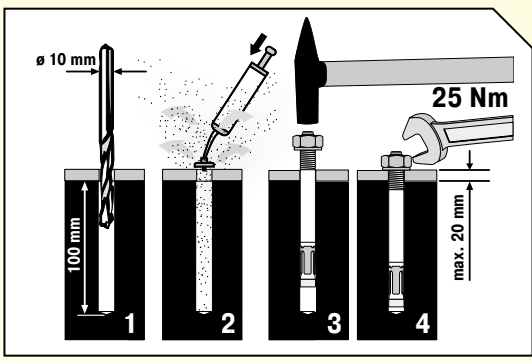

①	M10		4x
②	$\varnothing 10,5$		4x
③	M10	8.8	4x
④	M10-20		8x



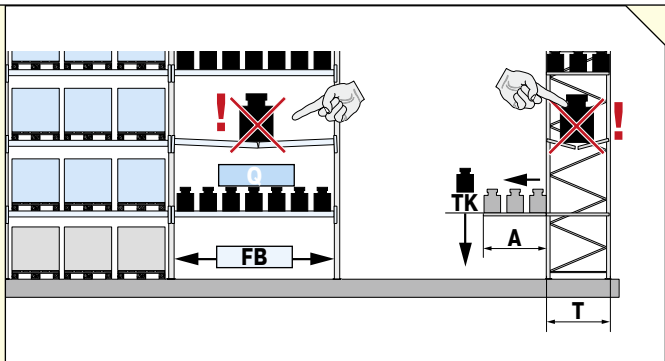

TK		Q (Fachlast/Level load)		
		FB = 950 mm	FB = 1800 mm	FB = 2700 mm
200 kg	A = 70 % T	510 kg	737 kg	964 kg
200 kg	A = 100 % T	643 kg	886 kg	1129 kg
300 kg	A = 100 % T	960 kg	1320 kg	1680 kg
600 kg	A = 70 % T	1476 kg	2112 kg	2748 kg
600 kg	A = 100 % T	1868 kg	2536 kg	3204 kg
800 kg	A = 70 % T	1974 kg	2828 kg	3682 kg
1000 kg	A = 70 % T	2488 kg	3576 kg	4664 kg
1000 kg	A = 100 % T	3098 kg	4196 kg	5294 kg

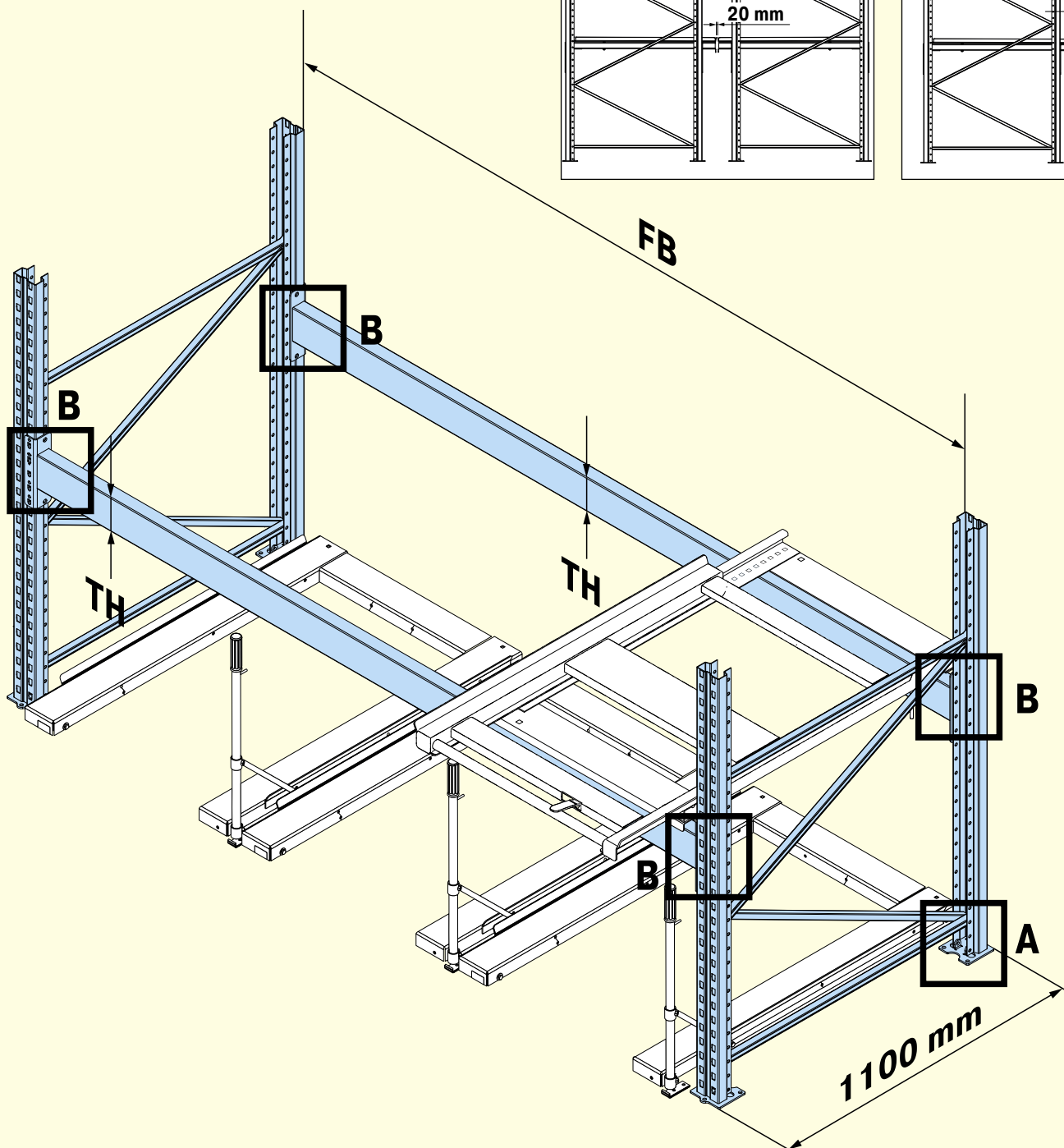
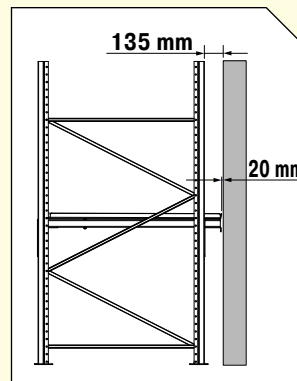
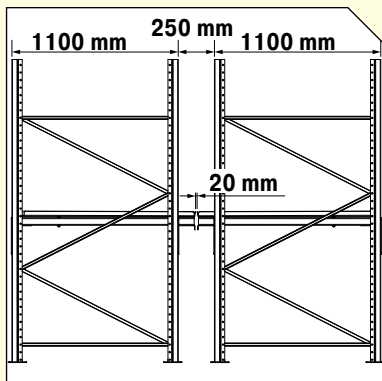

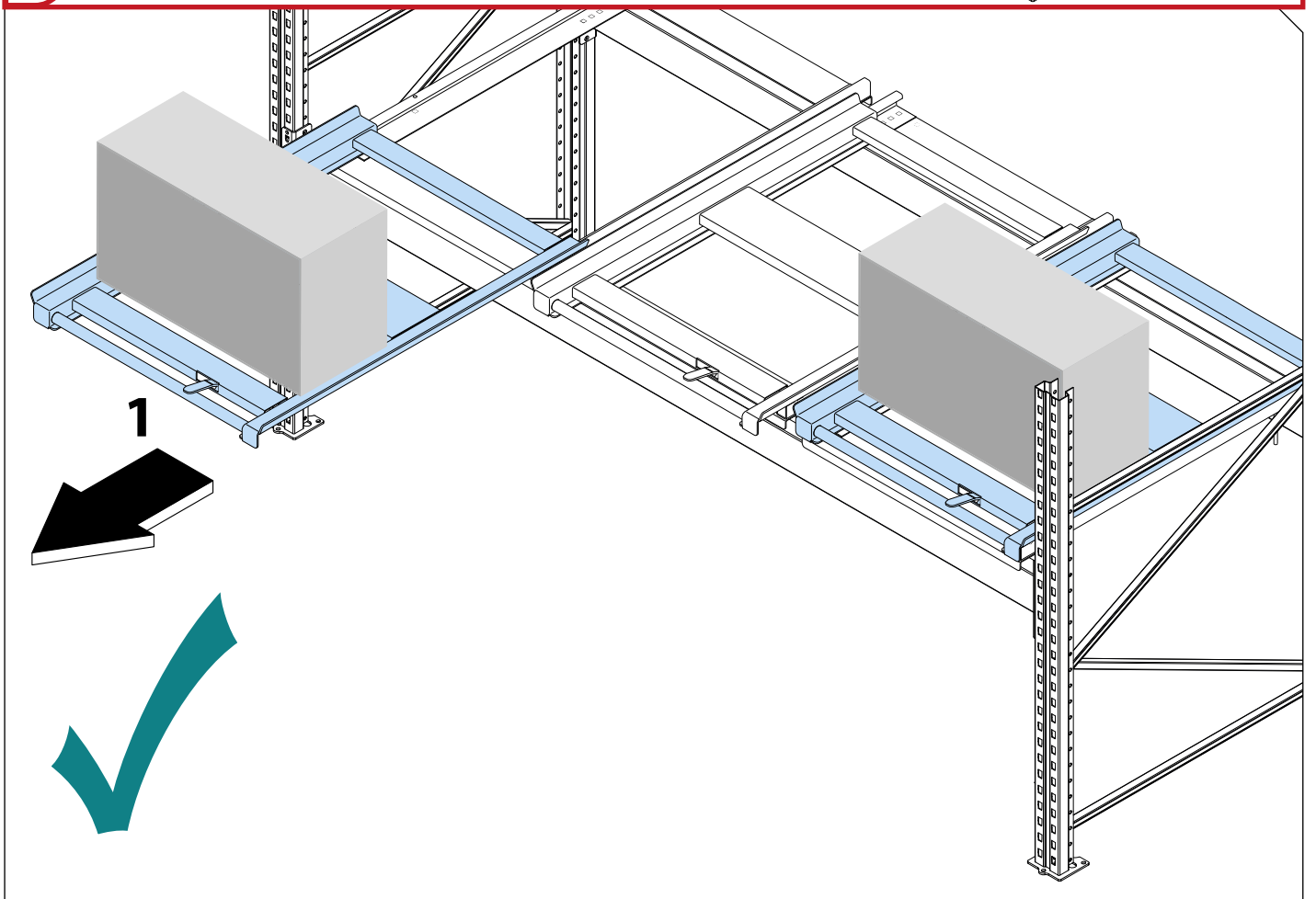
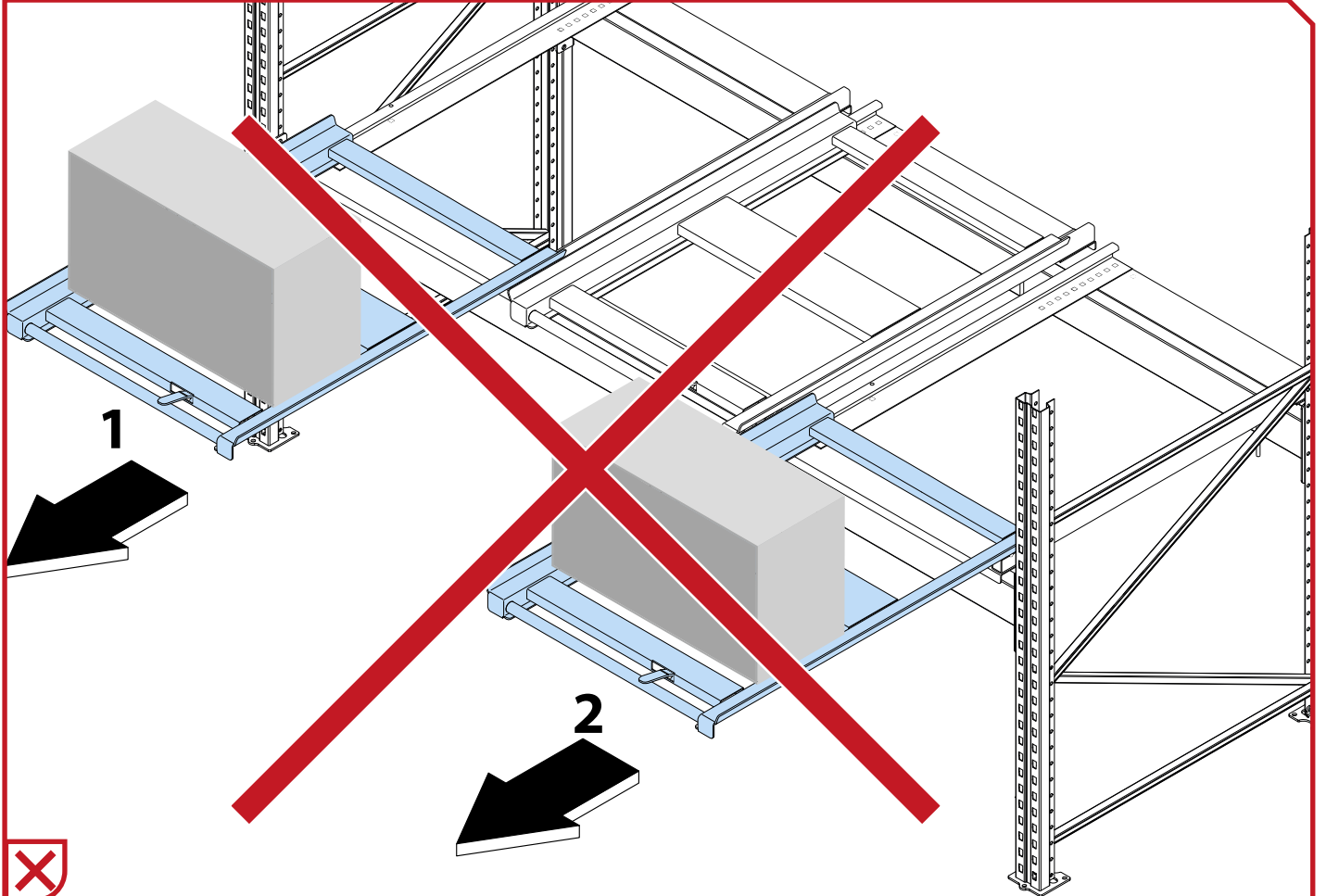

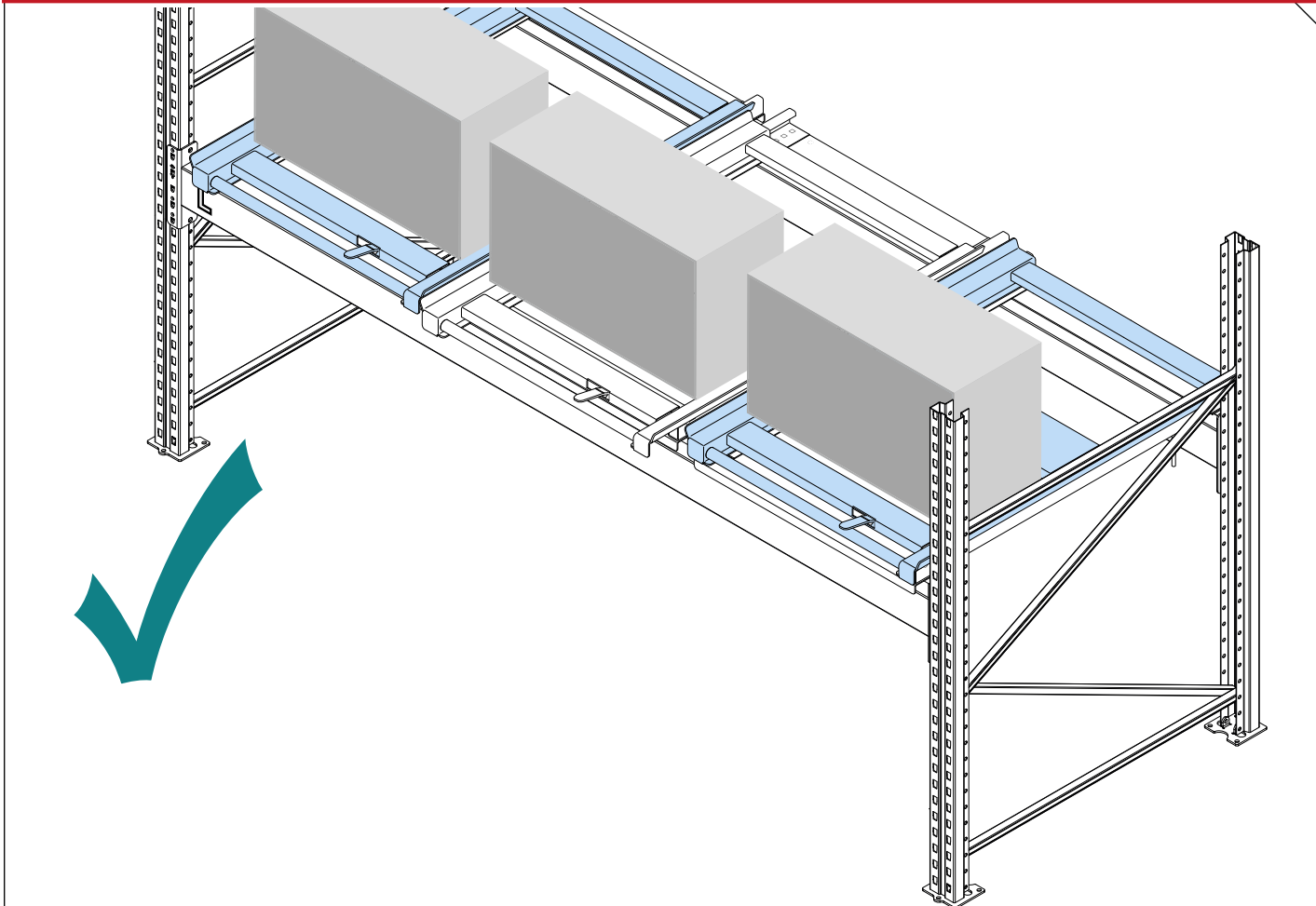
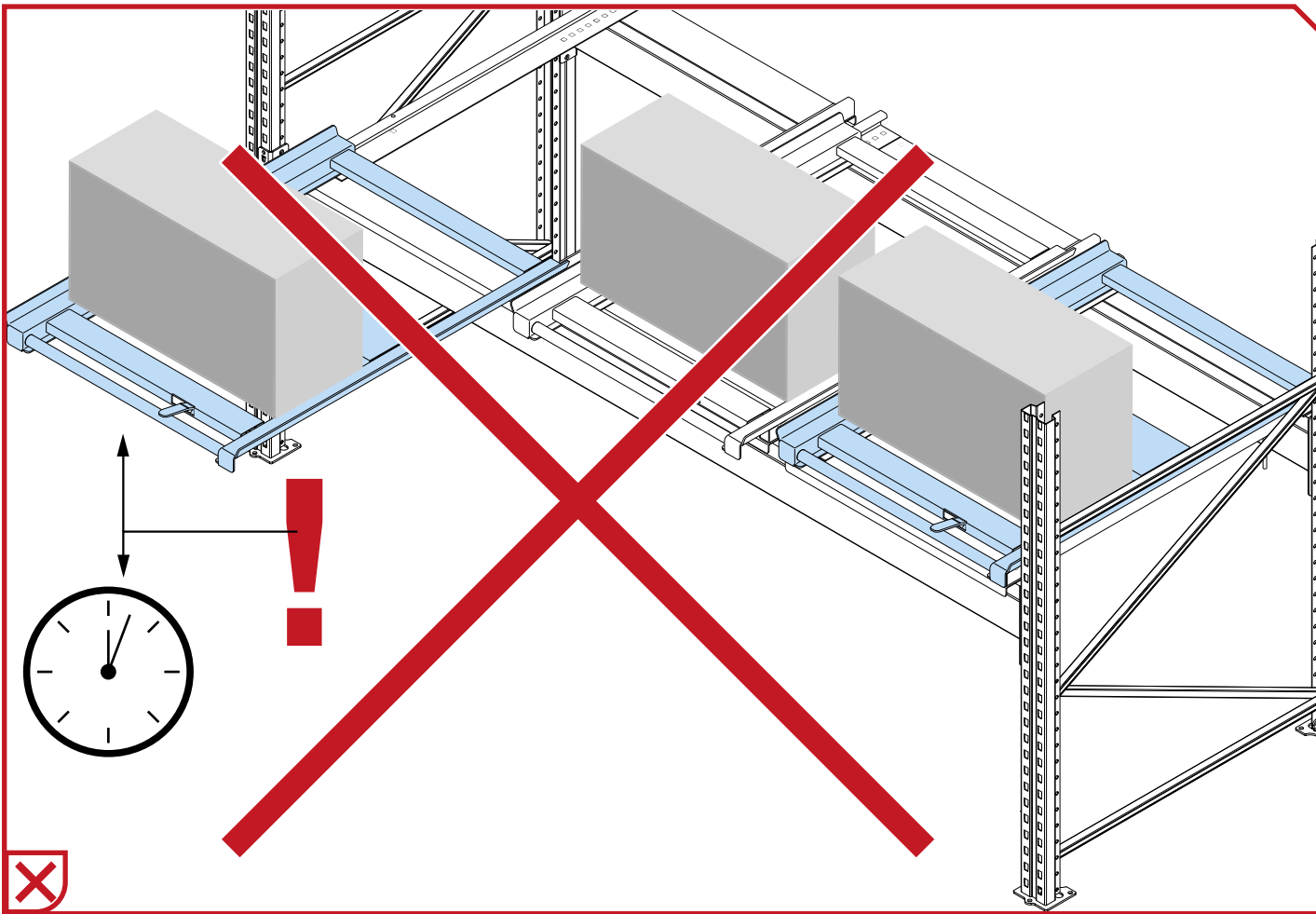

Auszugsvorrichtung

Extraction units

#33195 - 800 kg

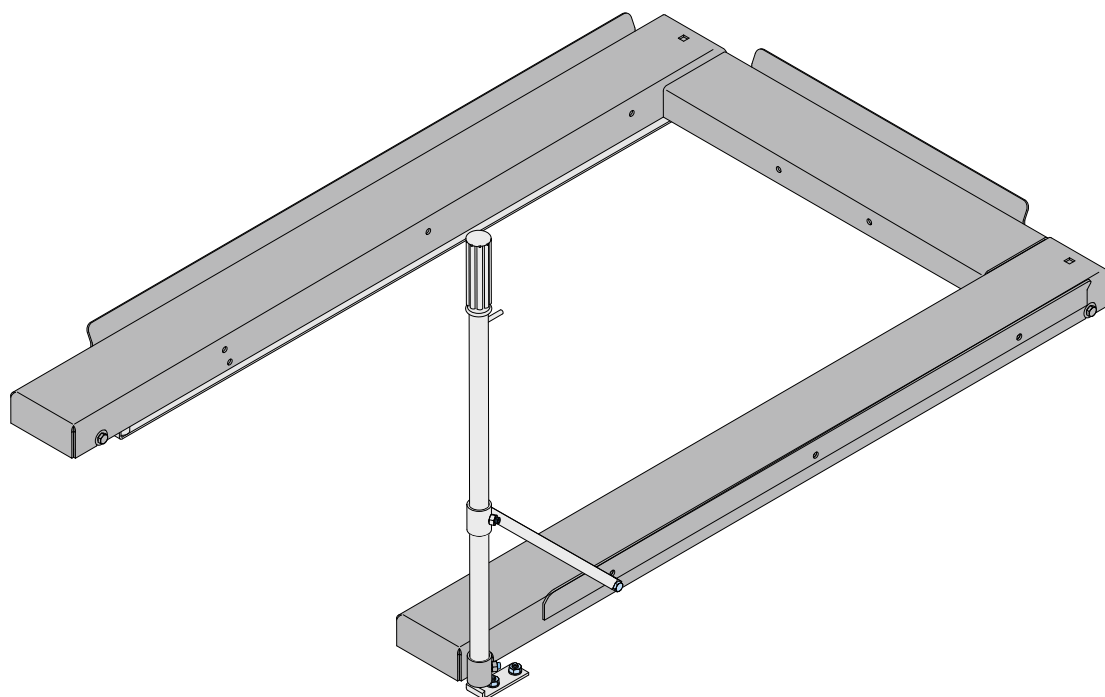
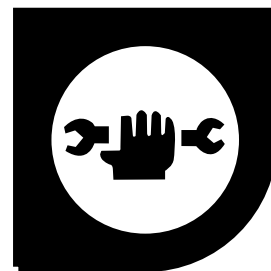

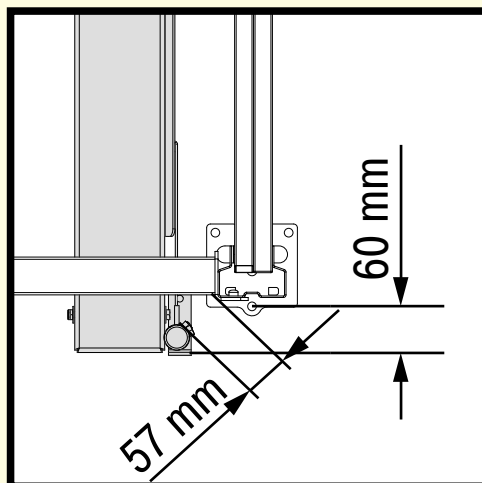
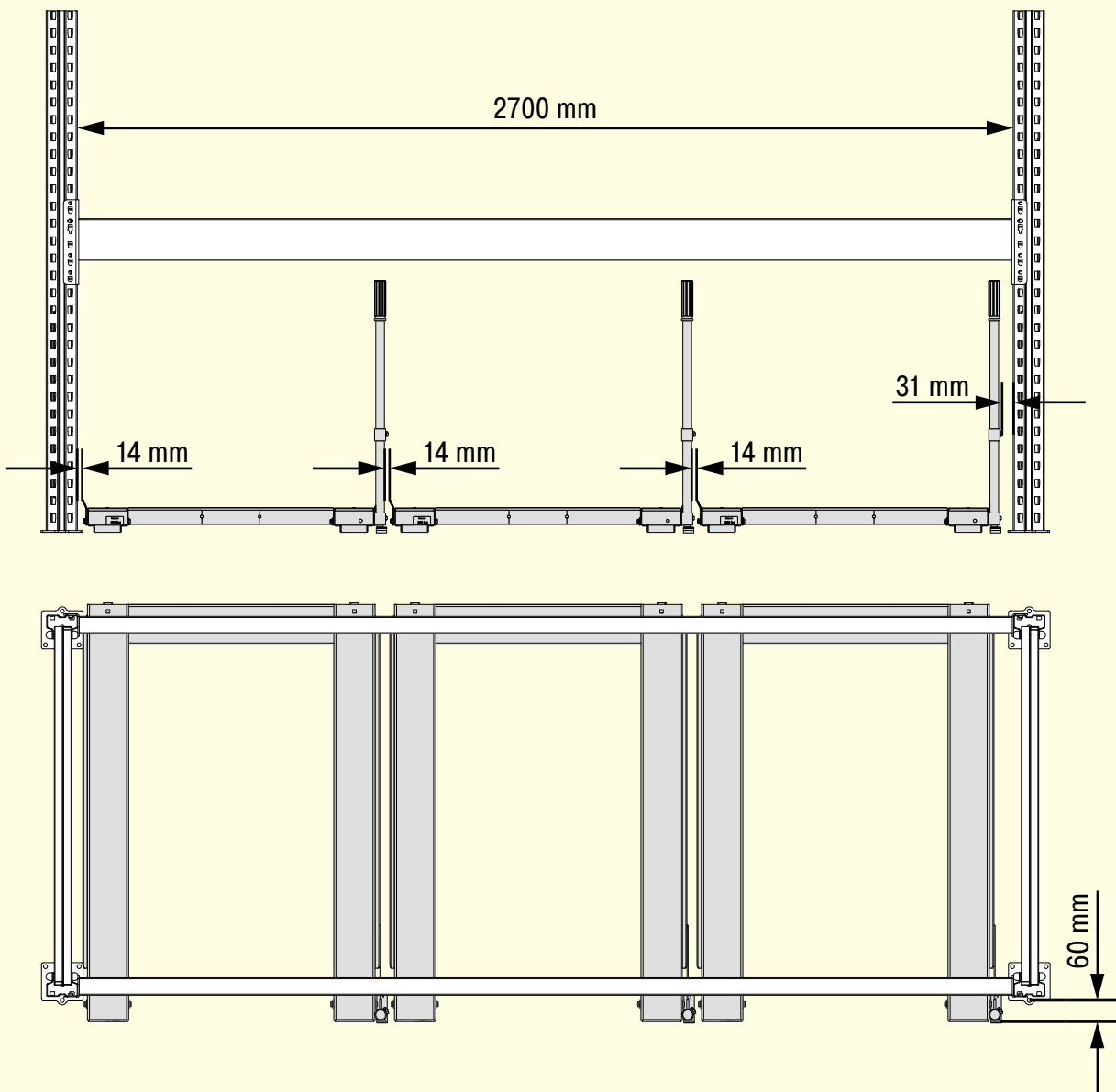



#33195 - 800 kg

M6-8.8	8 Nm	
M8-8.8	22 Nm	
M10-8.8	45 Nm	
M10-10.9	70 Nm	
M12-8.8	70 Nm	
M12-10.9	110 Nm	

①		M8	6x
②		M8 x 16	8.8
④		M8	1x
⑥			2x
⑦			1x
⑧			1x
⑨			2x
⑩			1x

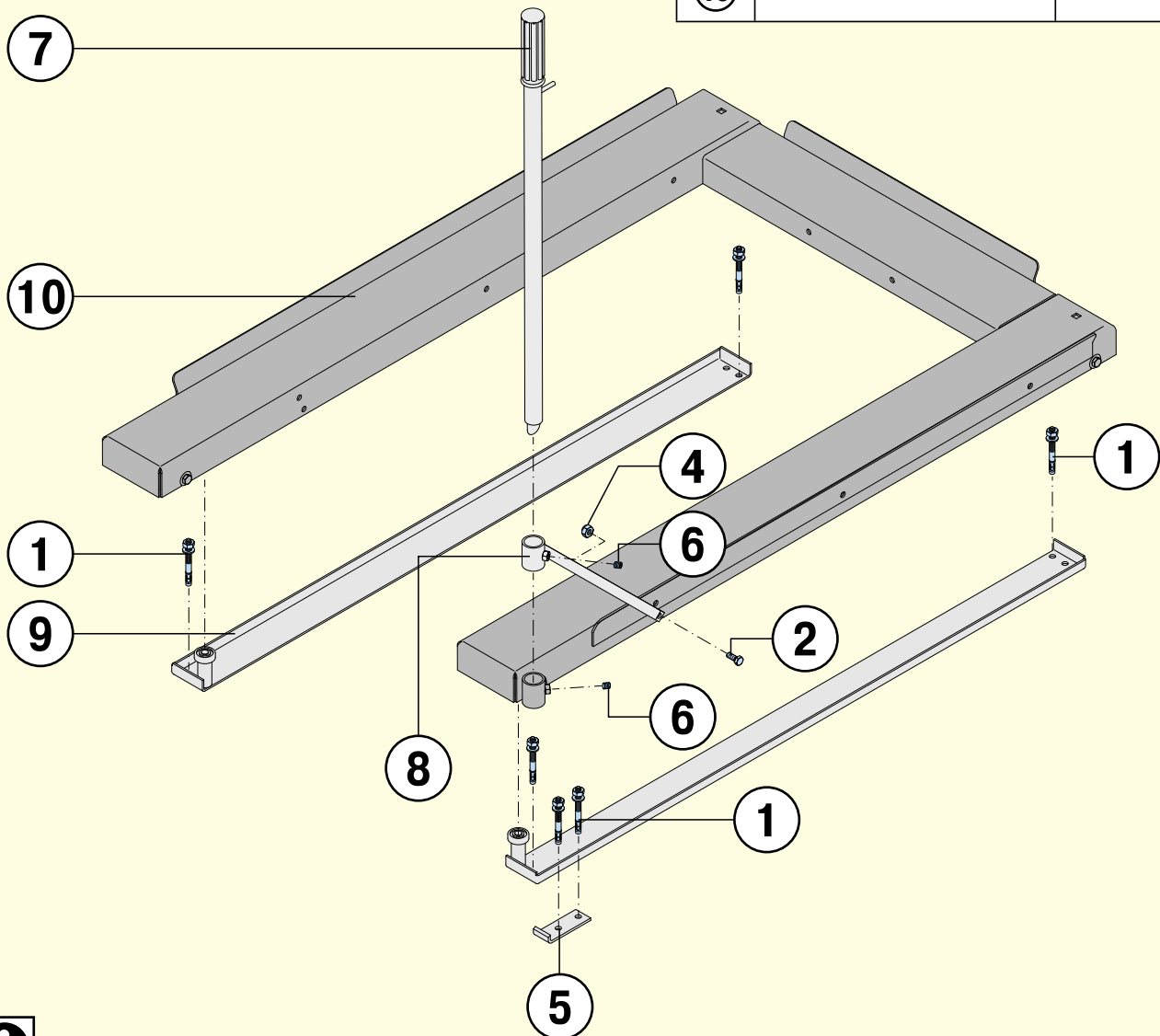

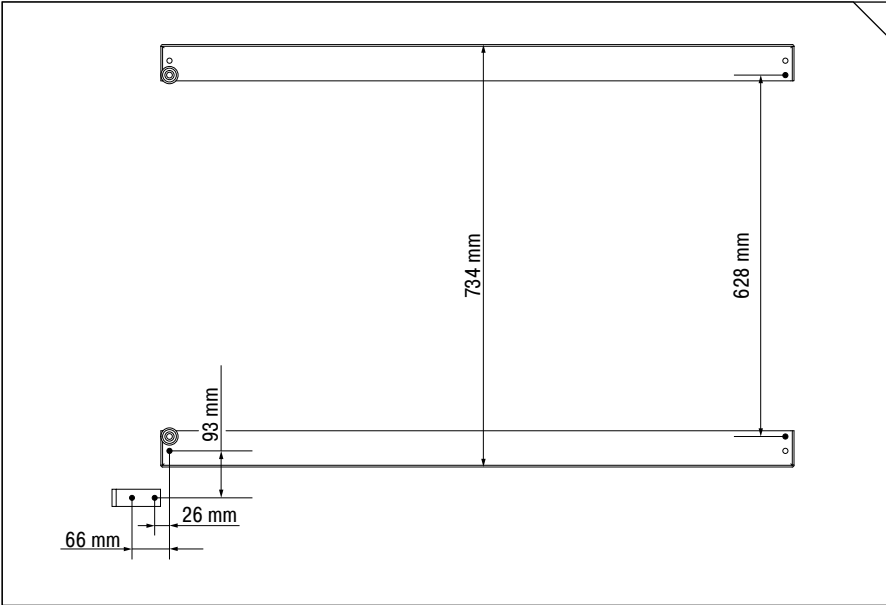

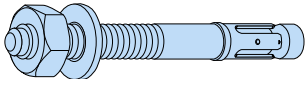
①	 M8	6x
⑨		2x
⑤		1x

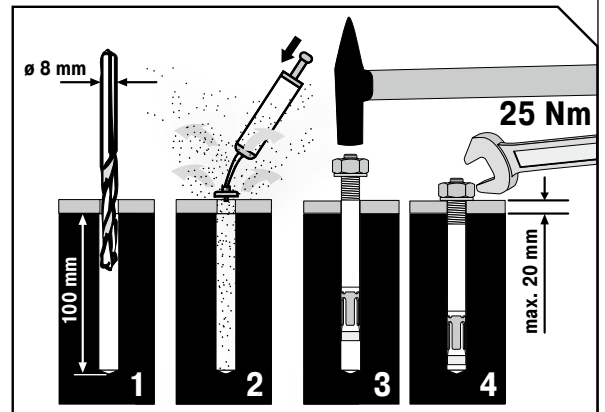
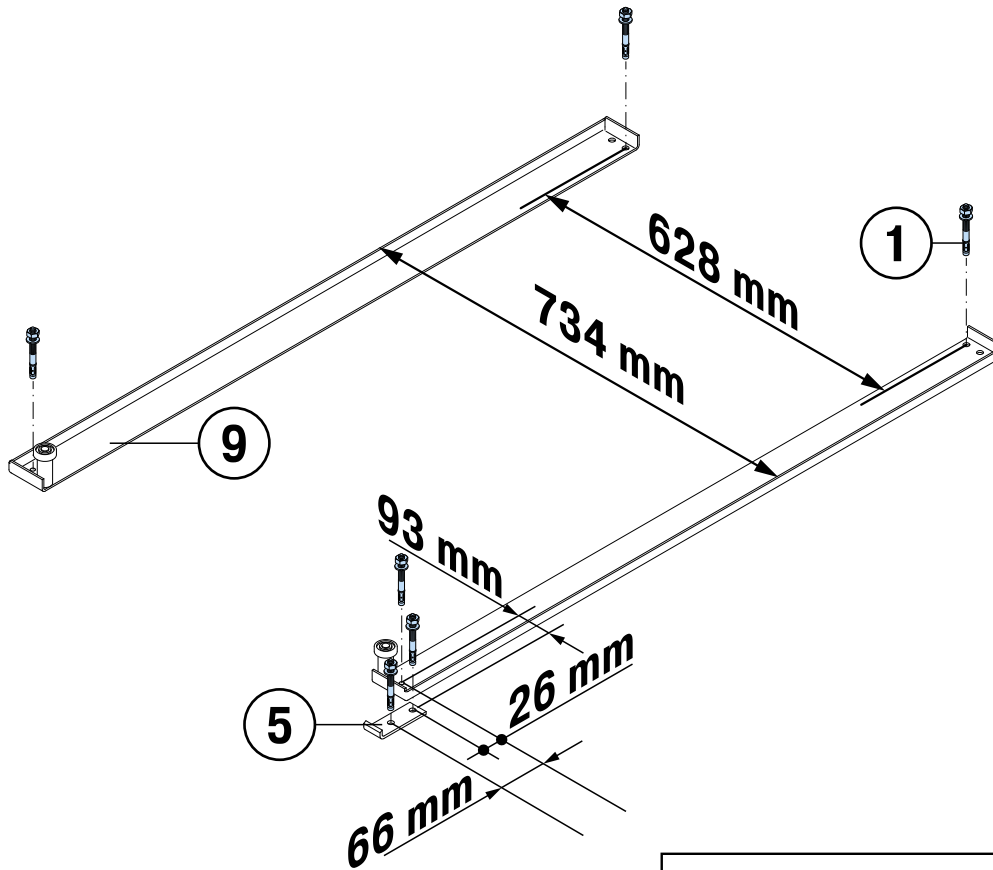

1

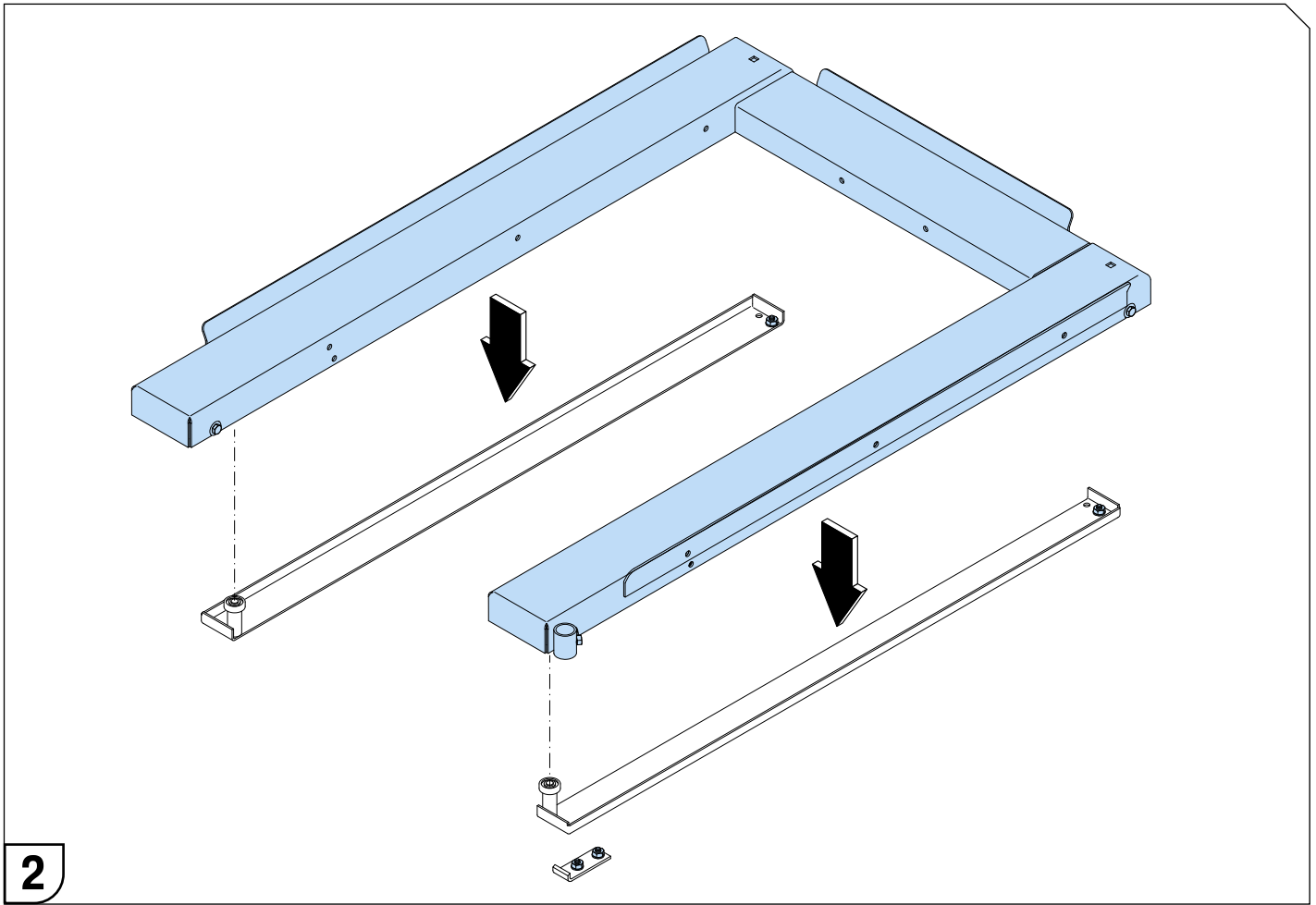

2

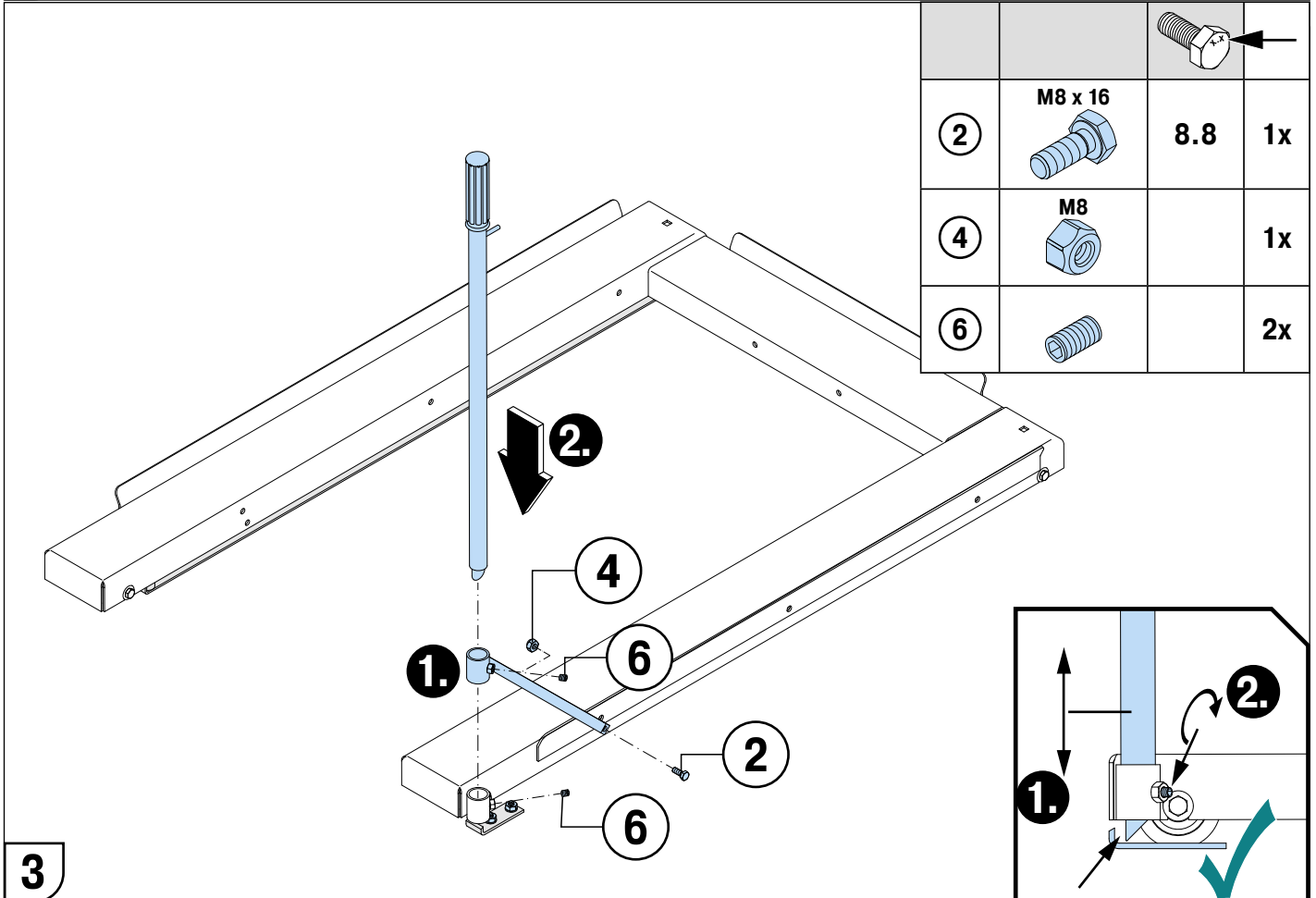

3

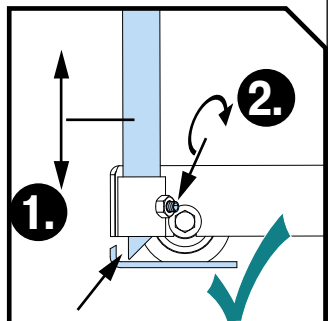



②	M8 x 16		8.8 1x
④	M8		1x
⑥			2x

M6-8.8	8 Nm	
M8-8.8	22 Nm	
M10-8.8	45 Nm	
M10-10.9	70 Nm	
M12-8.8	70 Nm	
M12-10.9	110 Nm	

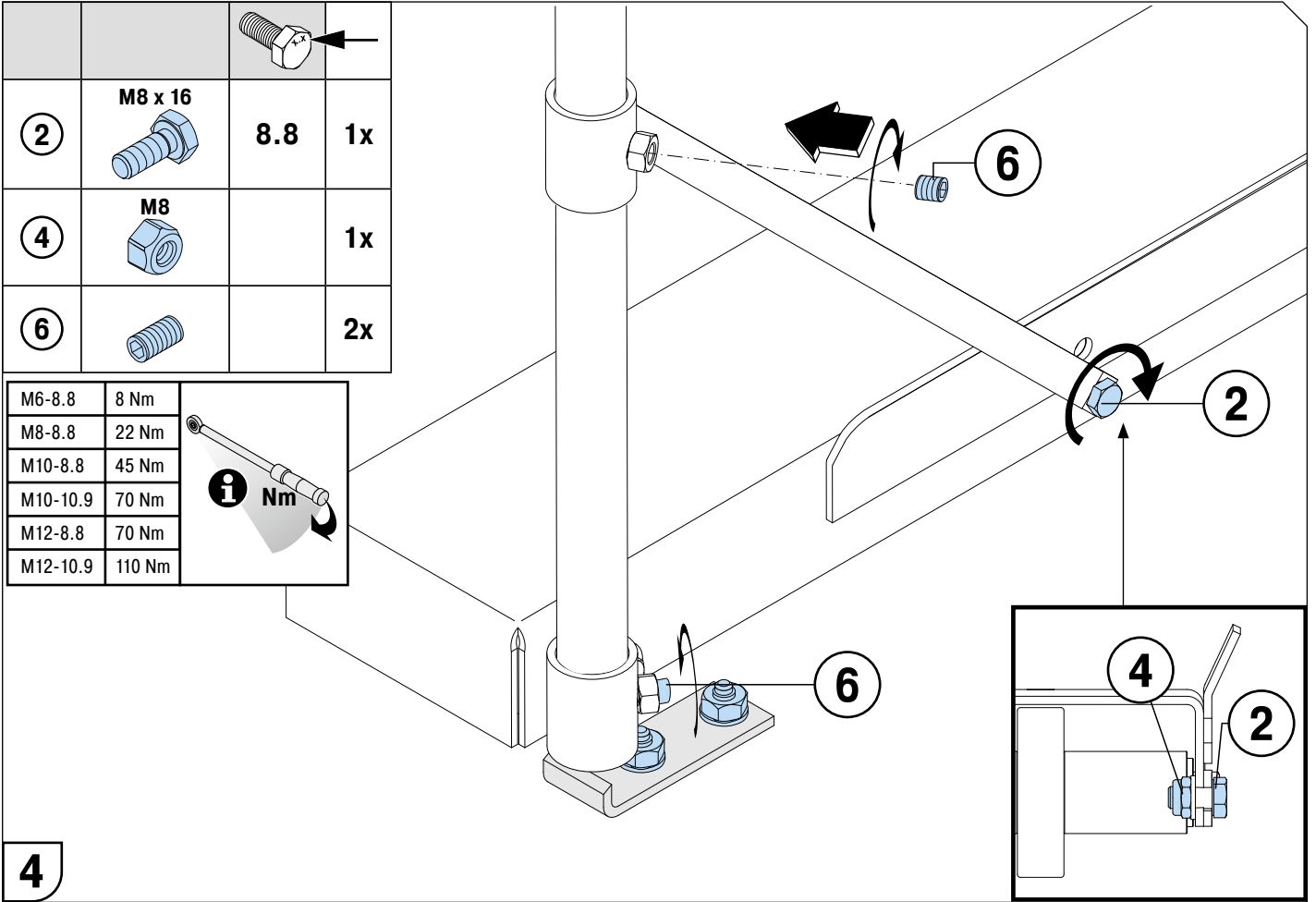

4

Auszugsvorrichtung

Extraction units

#33196 - 1000 kg

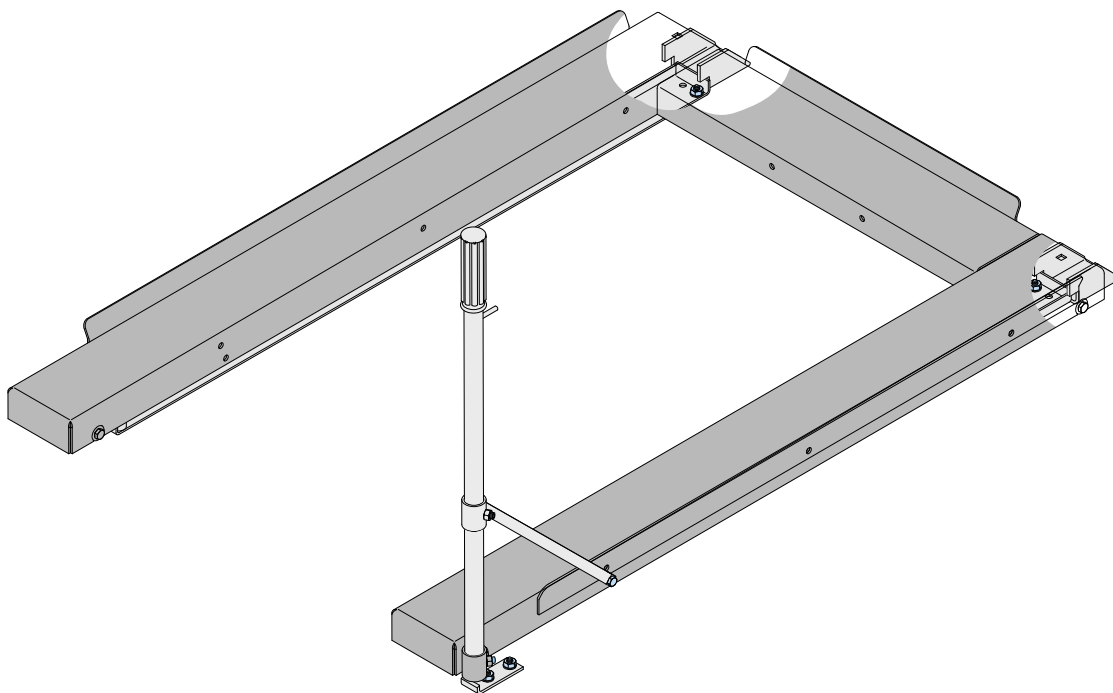
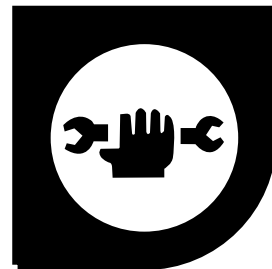

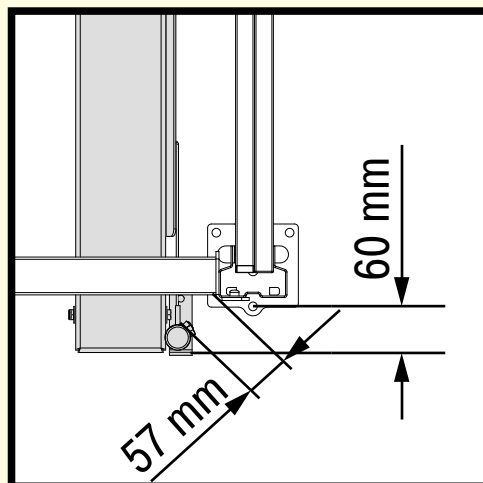
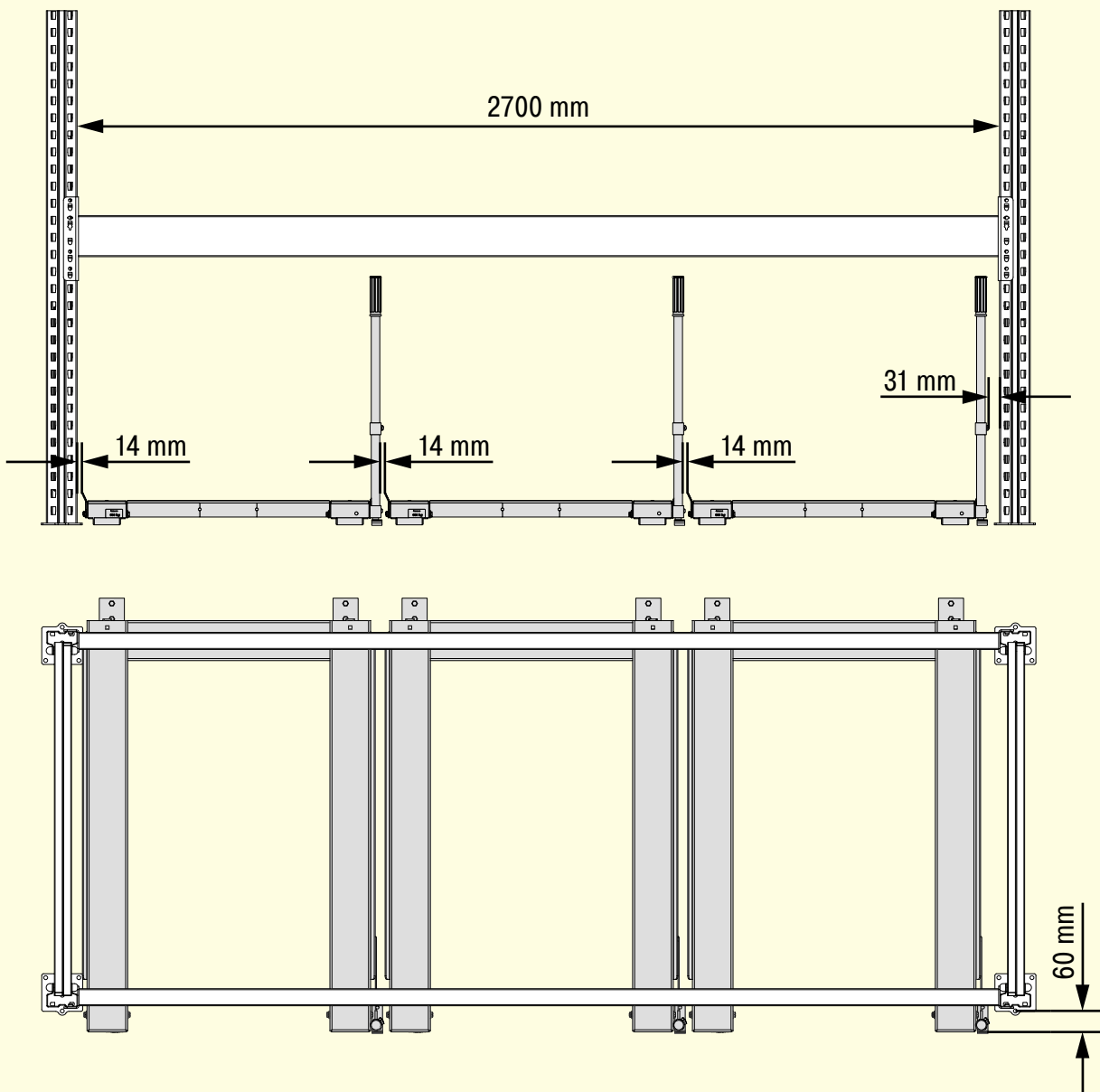



#33196 - 1000 kg

4 - 5 Nm

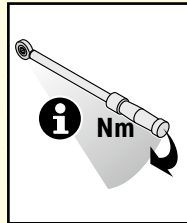

①		M8	10x
②		M8 x 16	8.8
④		M8	1x
⑥			2x
⑦			1x
⑧			1x
⑨			2x
⑩			1x
⑪			2x

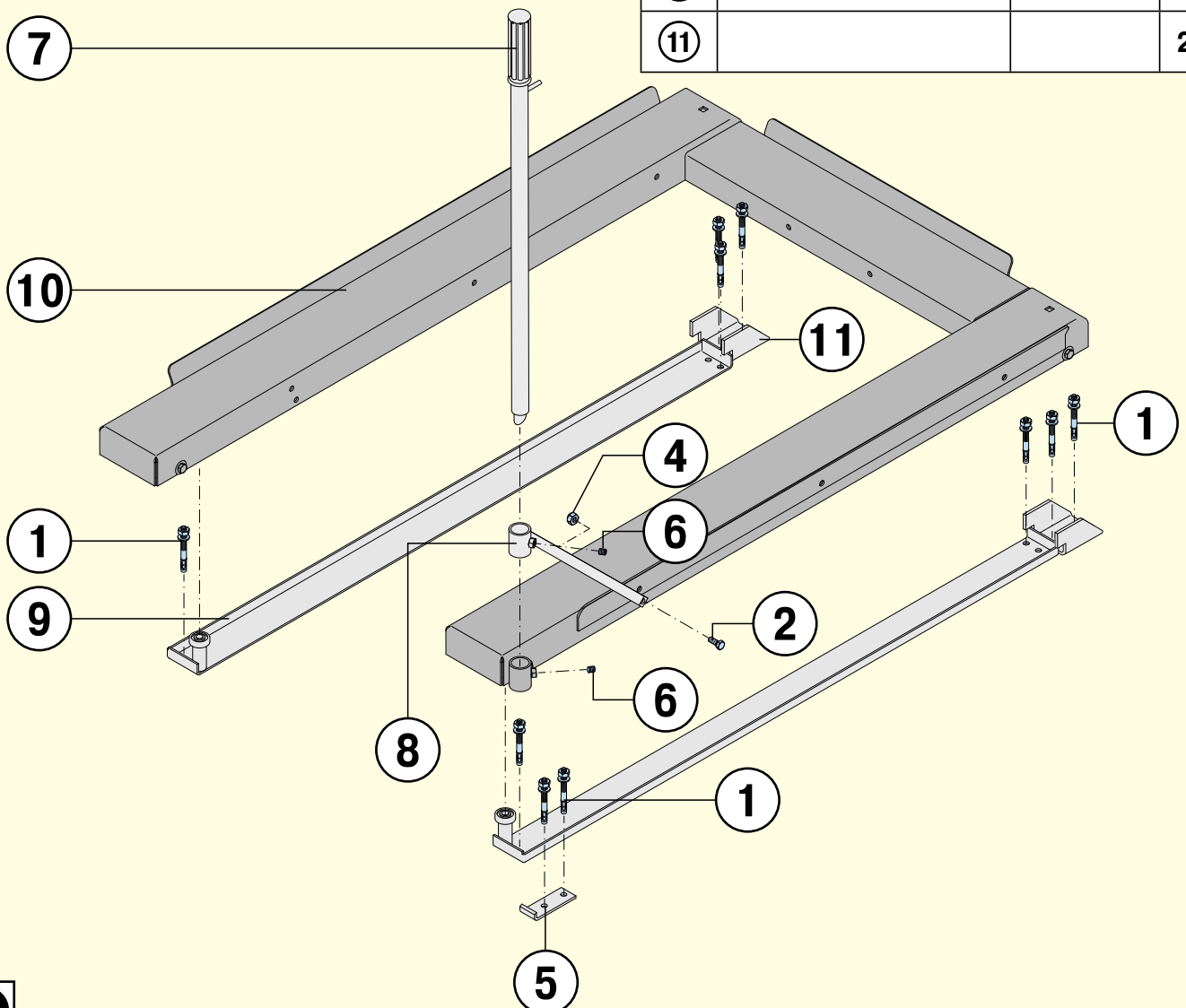

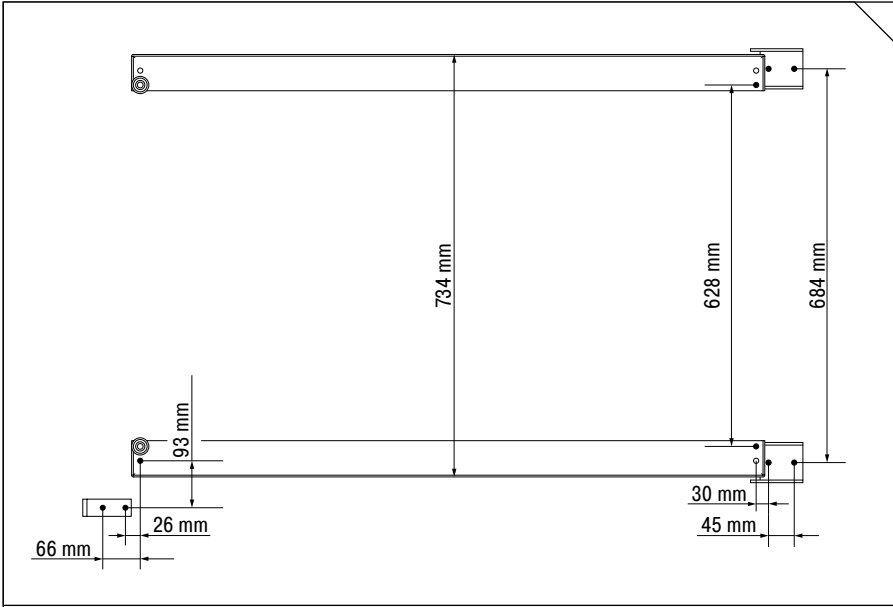

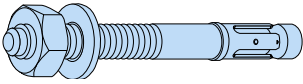
①	 M8	10x
⑨		2x
⑤		1x

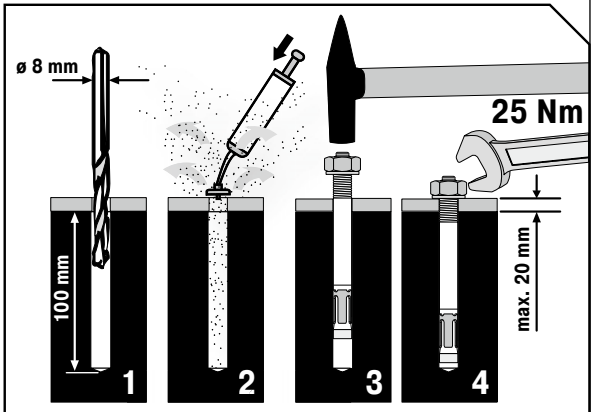
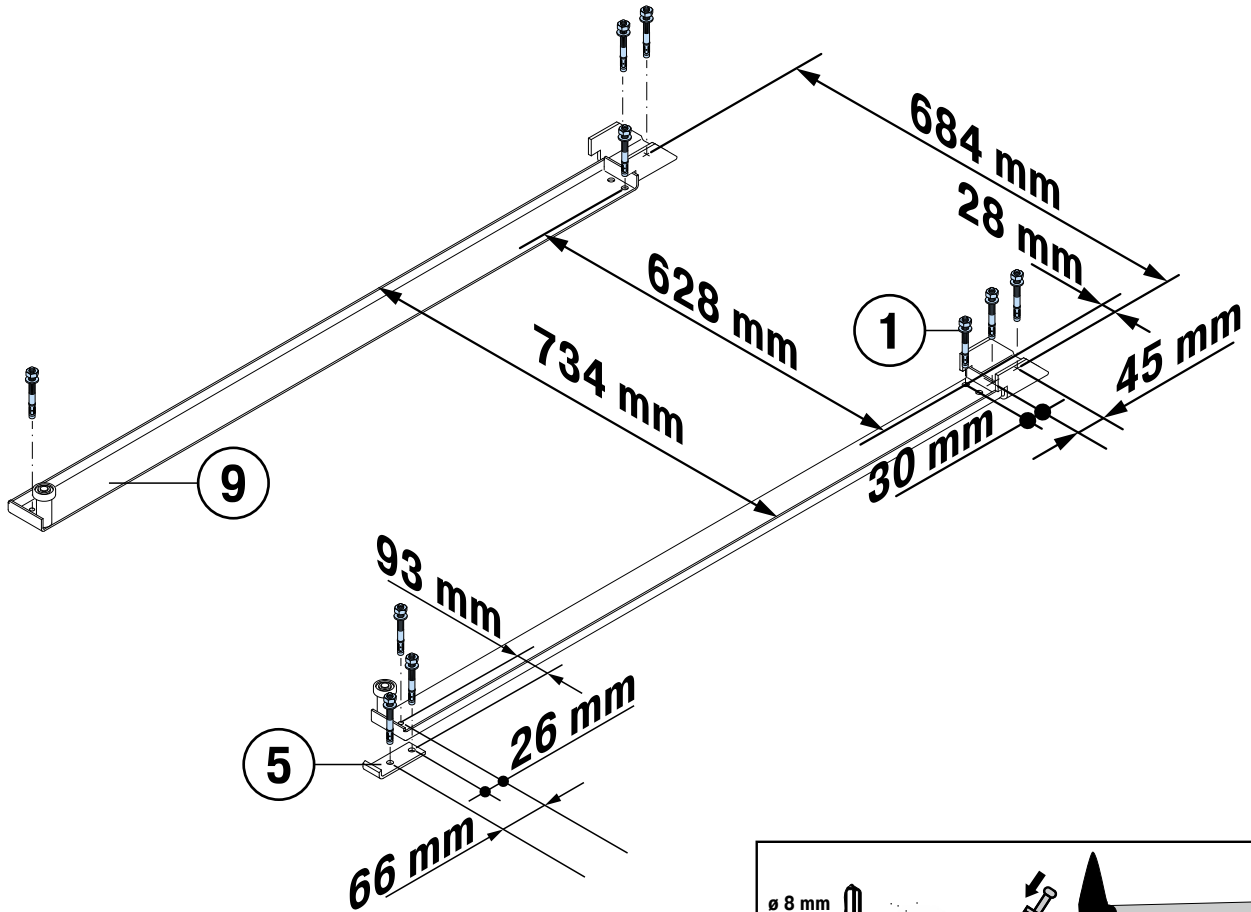

1

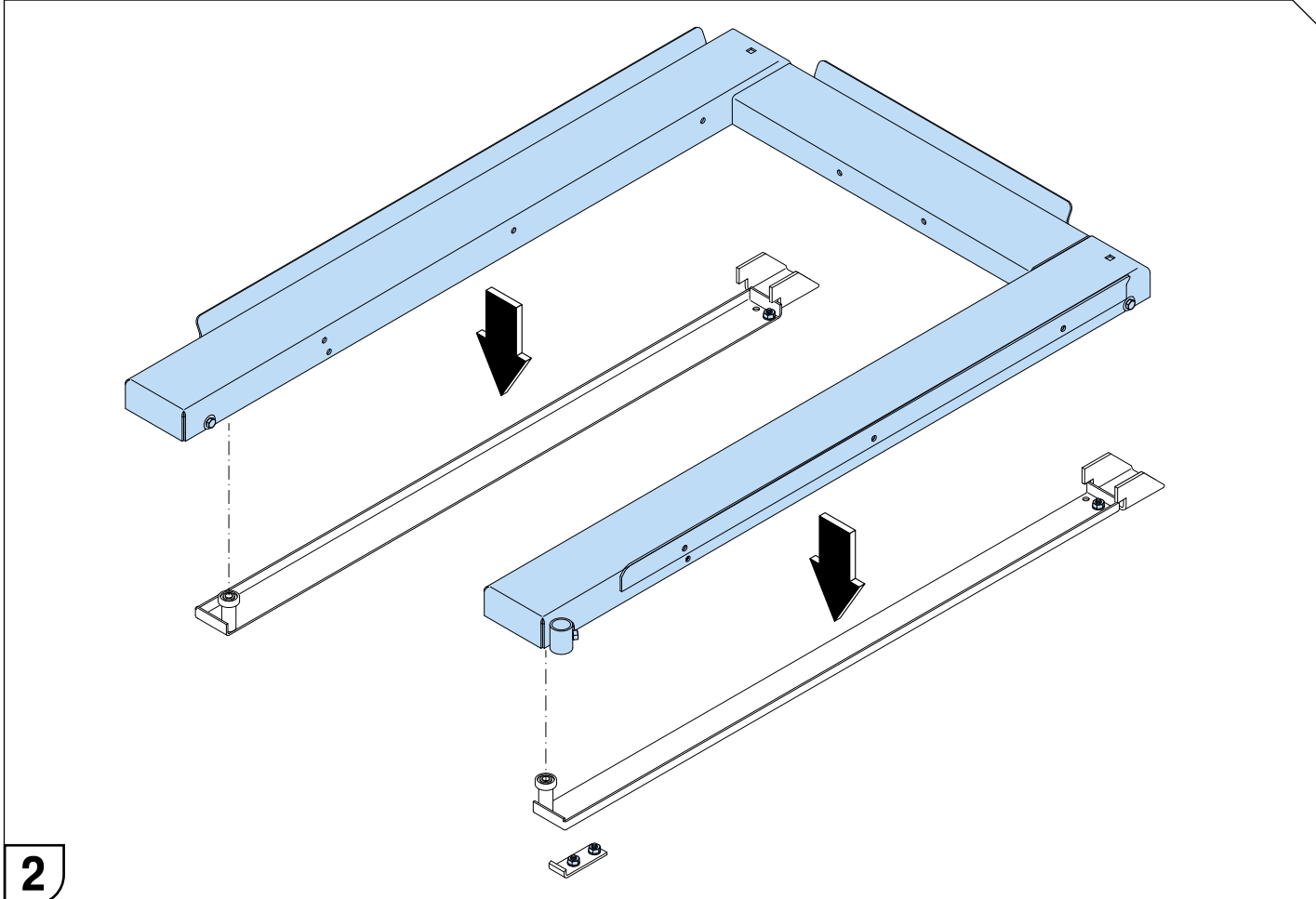

2

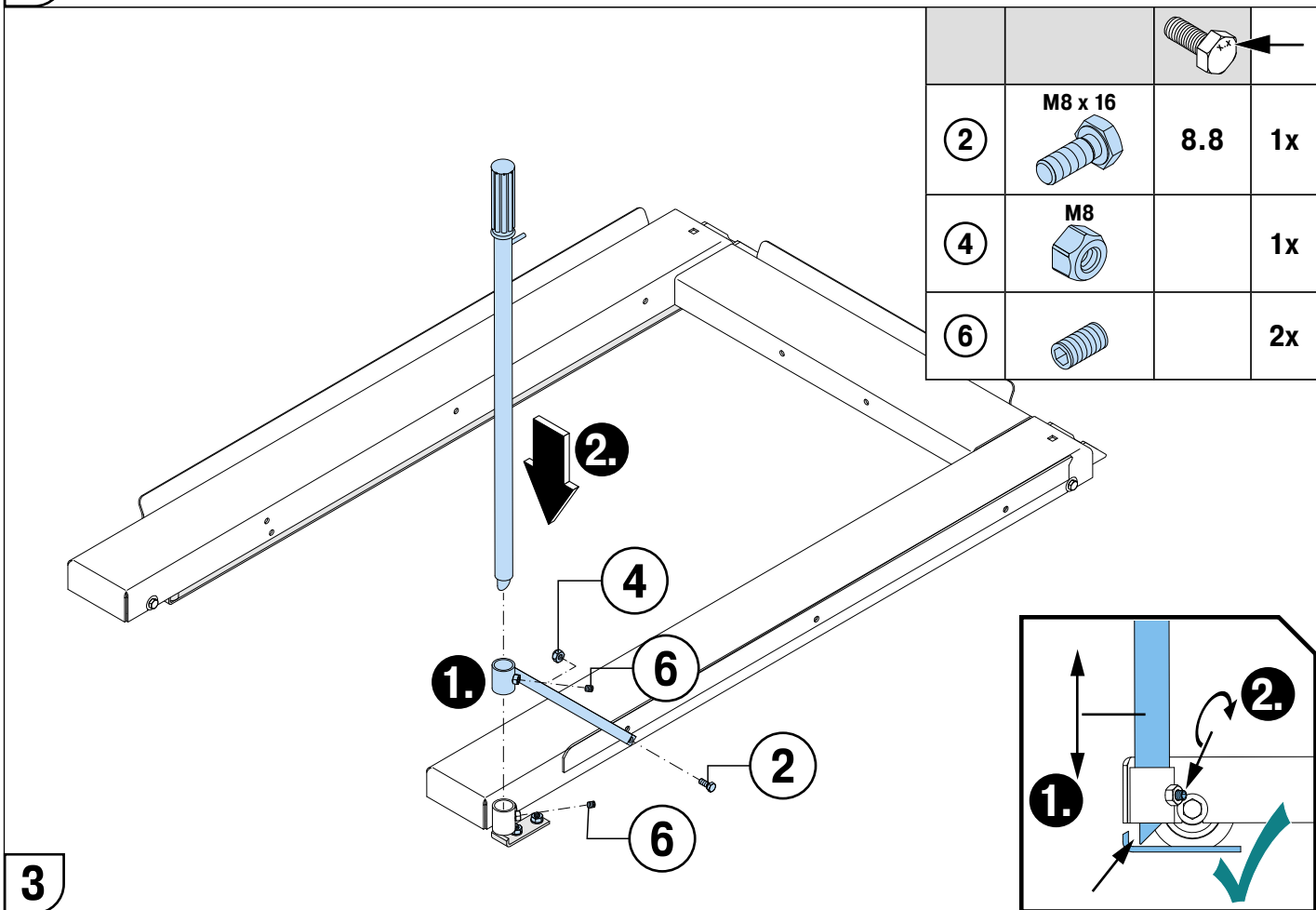

3

			←
2	M8 x 16		8.8 1x
4	M8		1x
6			2x

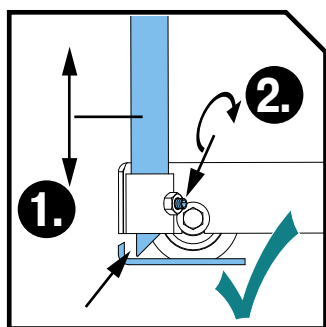

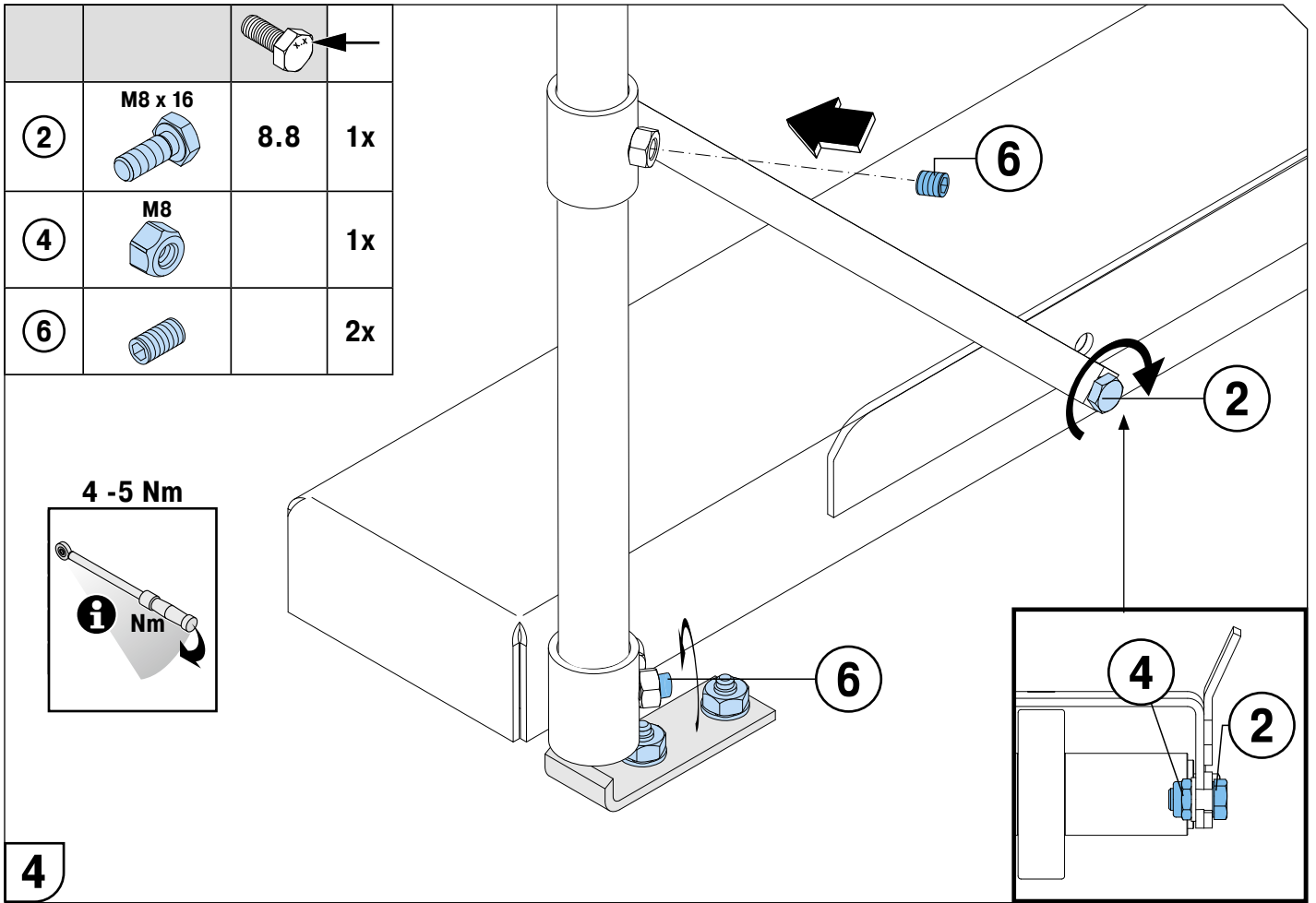

Auszugsvorrichtung

Extraction units

#33200 - 600 kg

#33201 - 800 kg

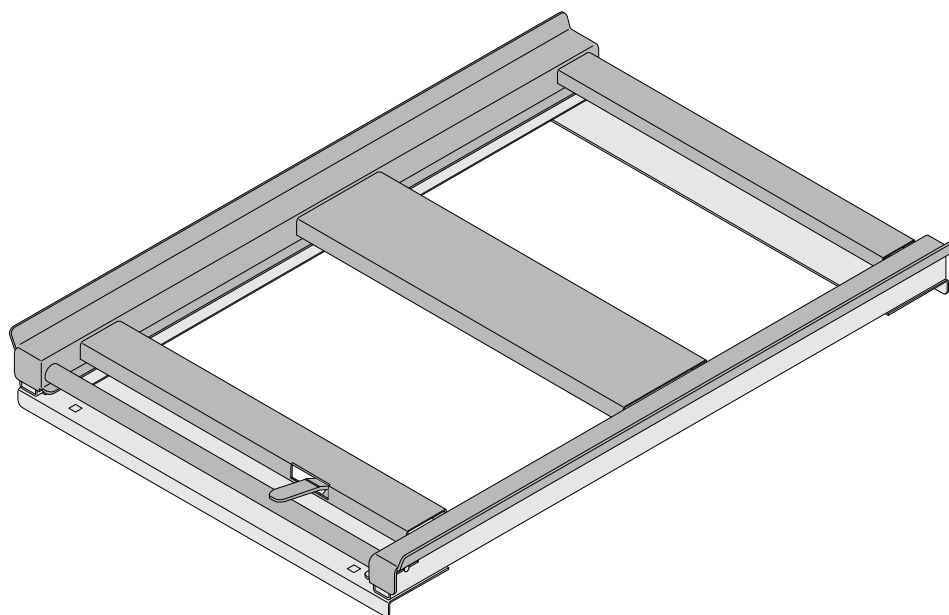
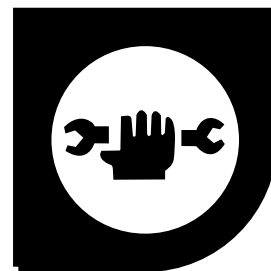



#33200 - 600 kg
#33201 - 800 kg

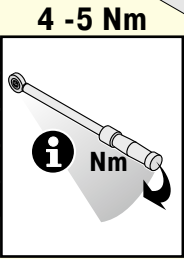
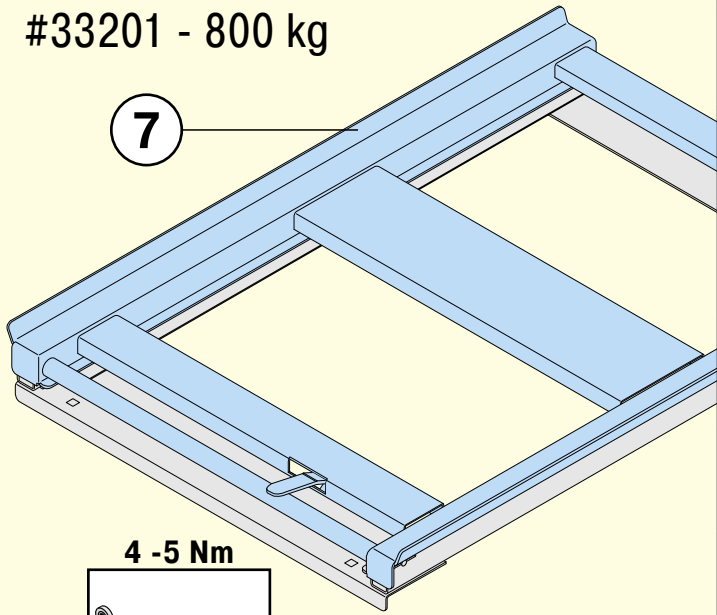

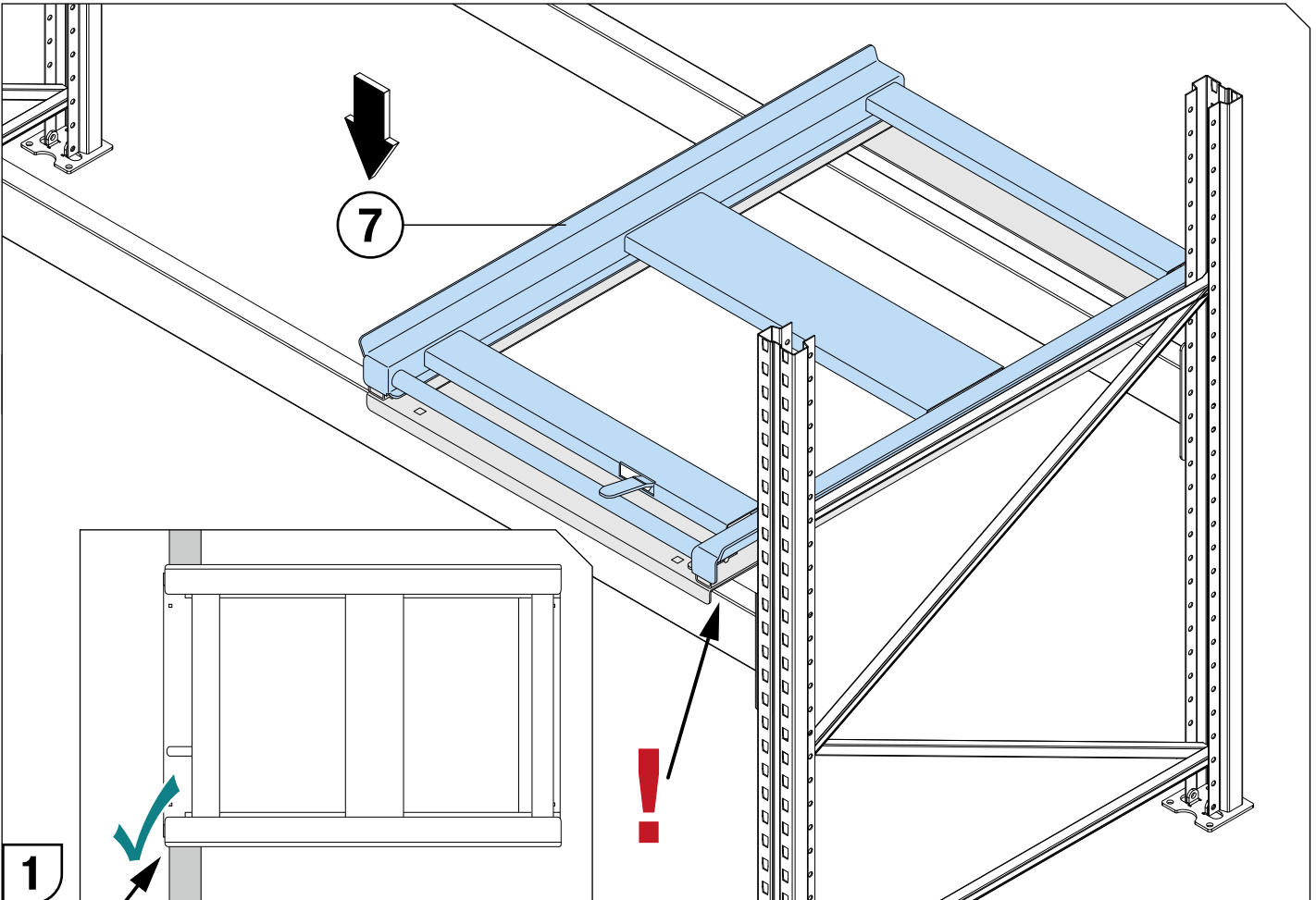

①	M8 x 160		8.8	4x
②	M8 x 200		8.8	4x
③	M8 x 20		8.8	2x
④	M8			6x
⑤	M8			6x
⑥	Platte 120 x 30 x 5			6x
⑦				1x

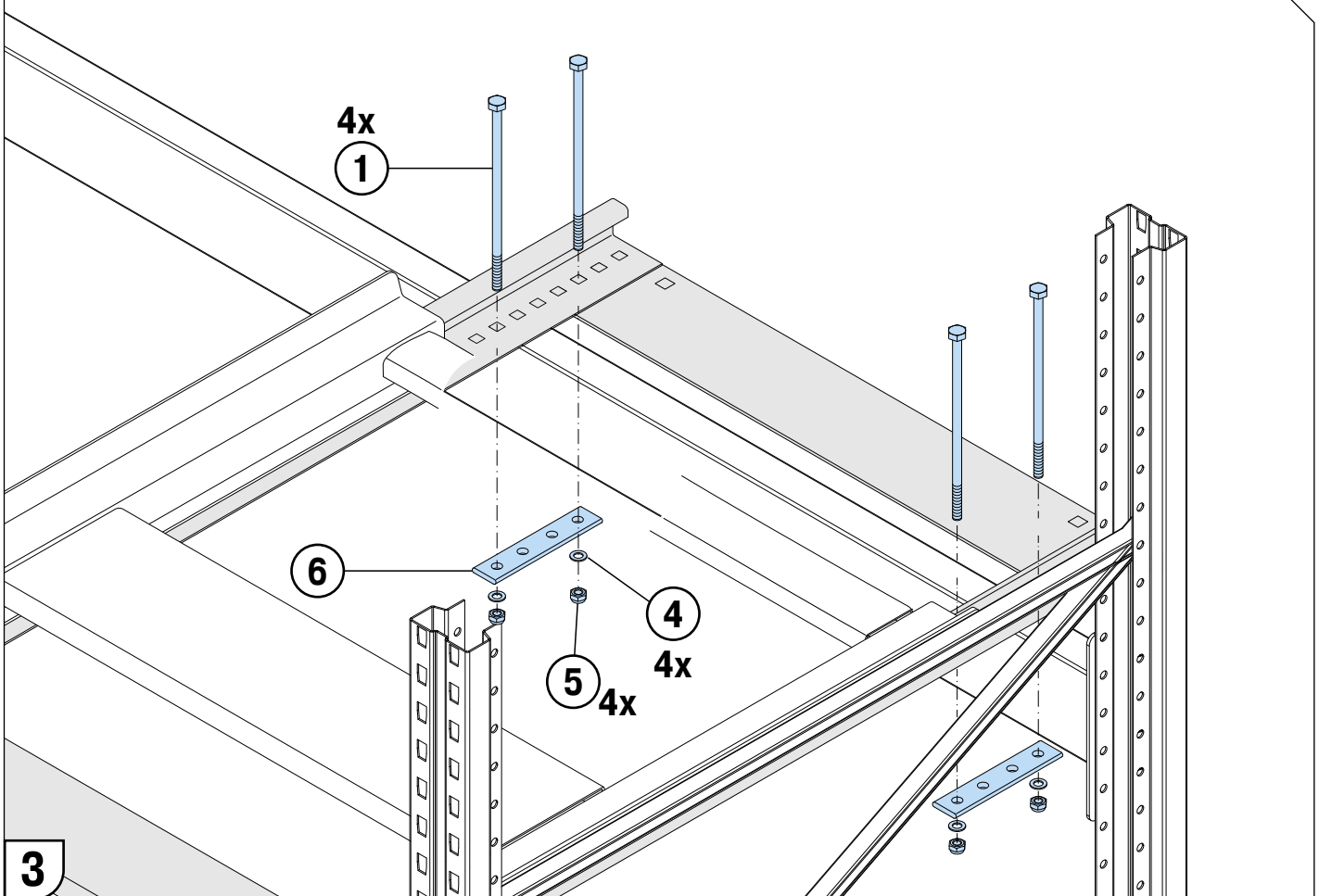
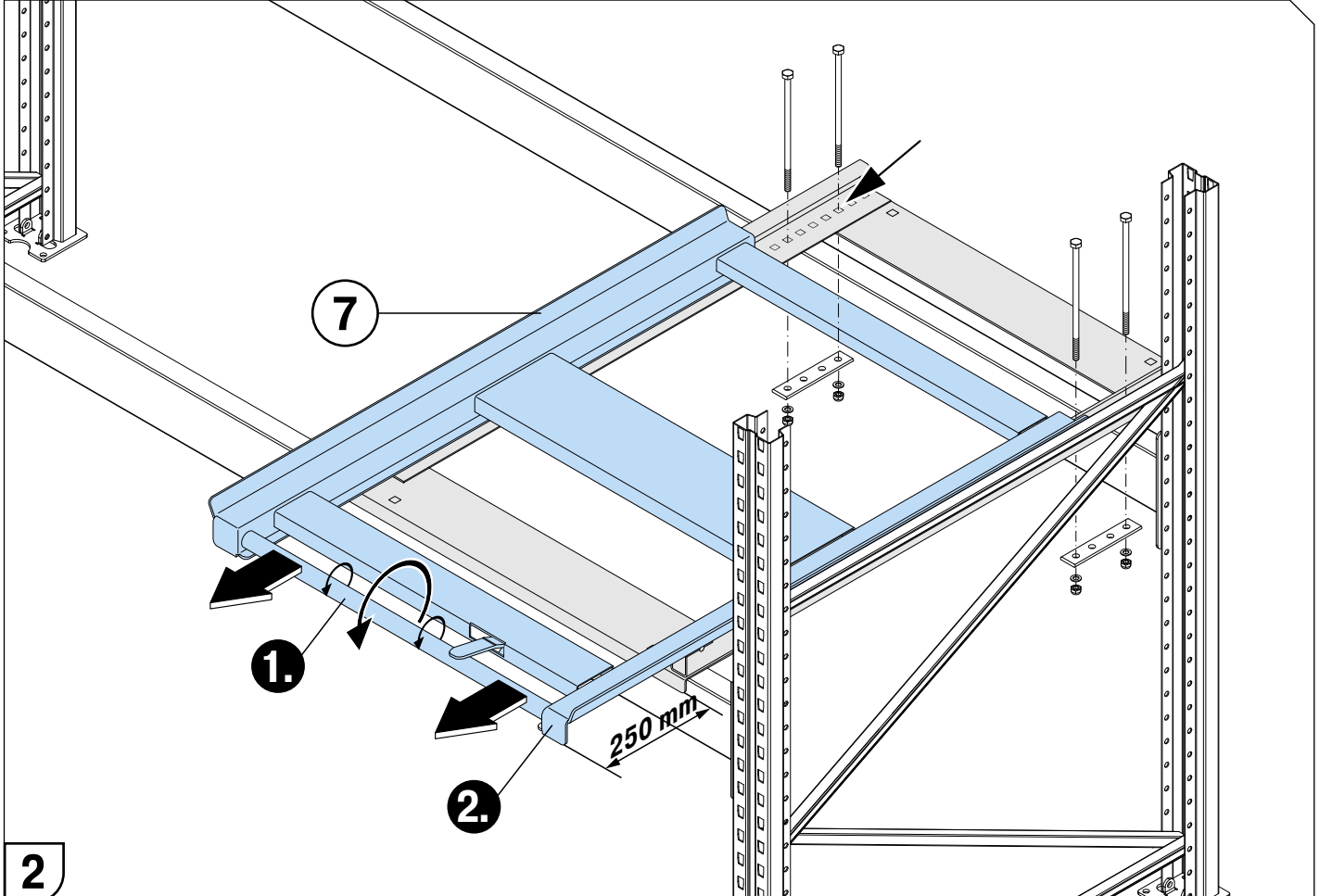

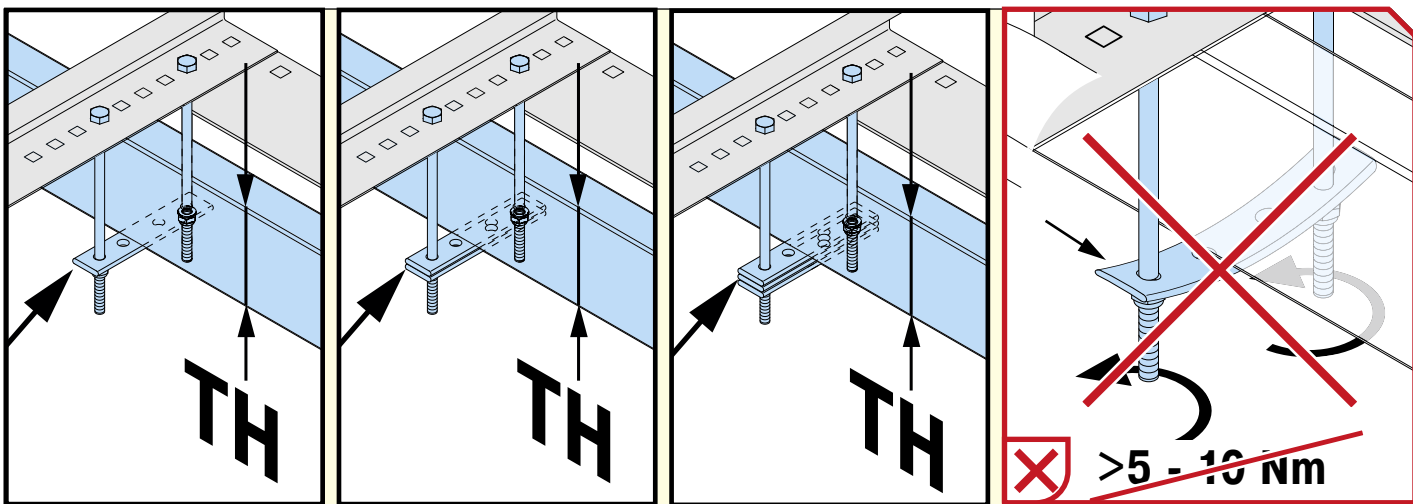
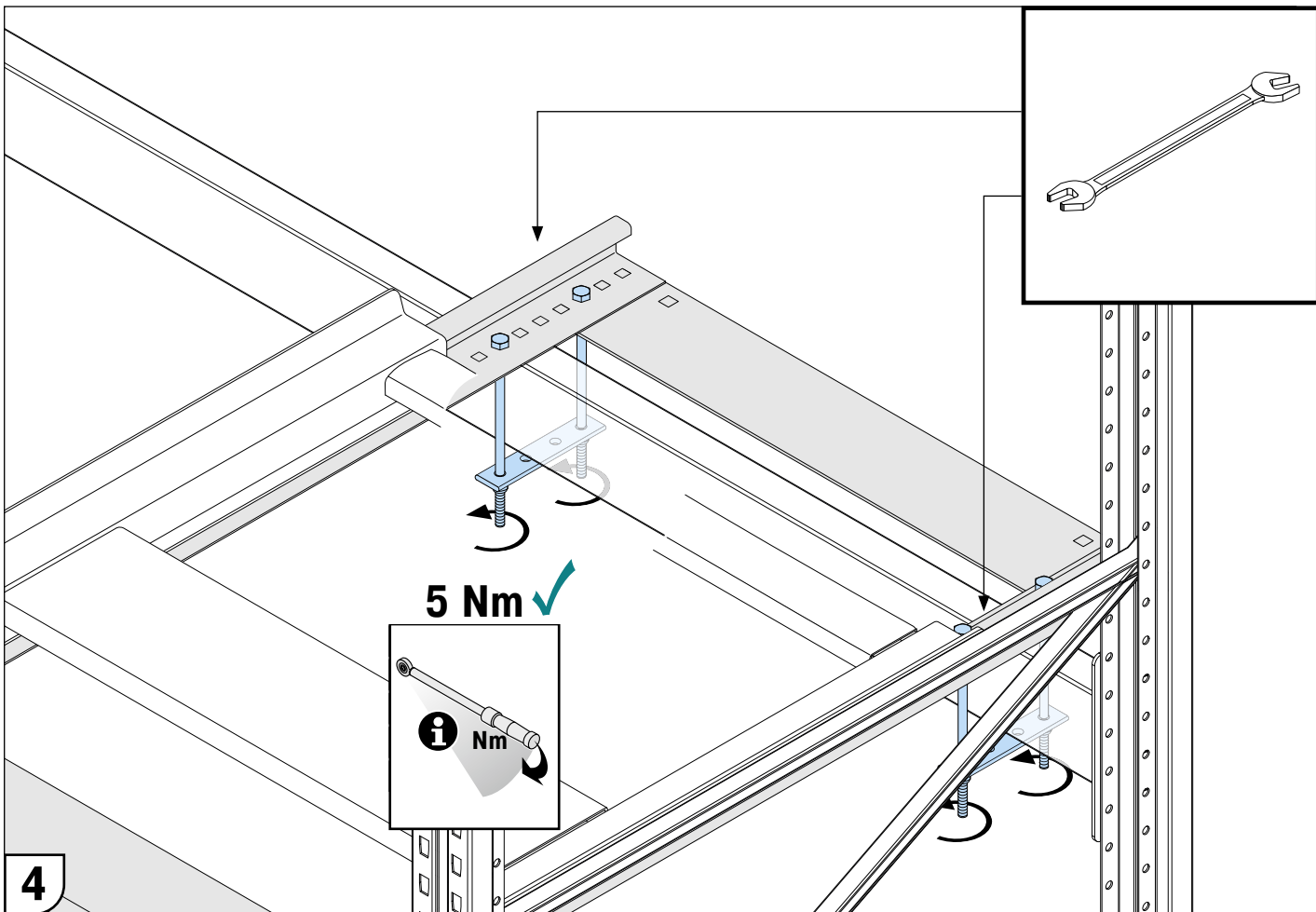

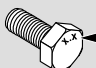

				TH
①	M8 x 160		8.8 4x	110 - 145 mm
②	M8 x 200		8.8 4x	145 - 170 mm

5 Nm ✓

i Nm

i

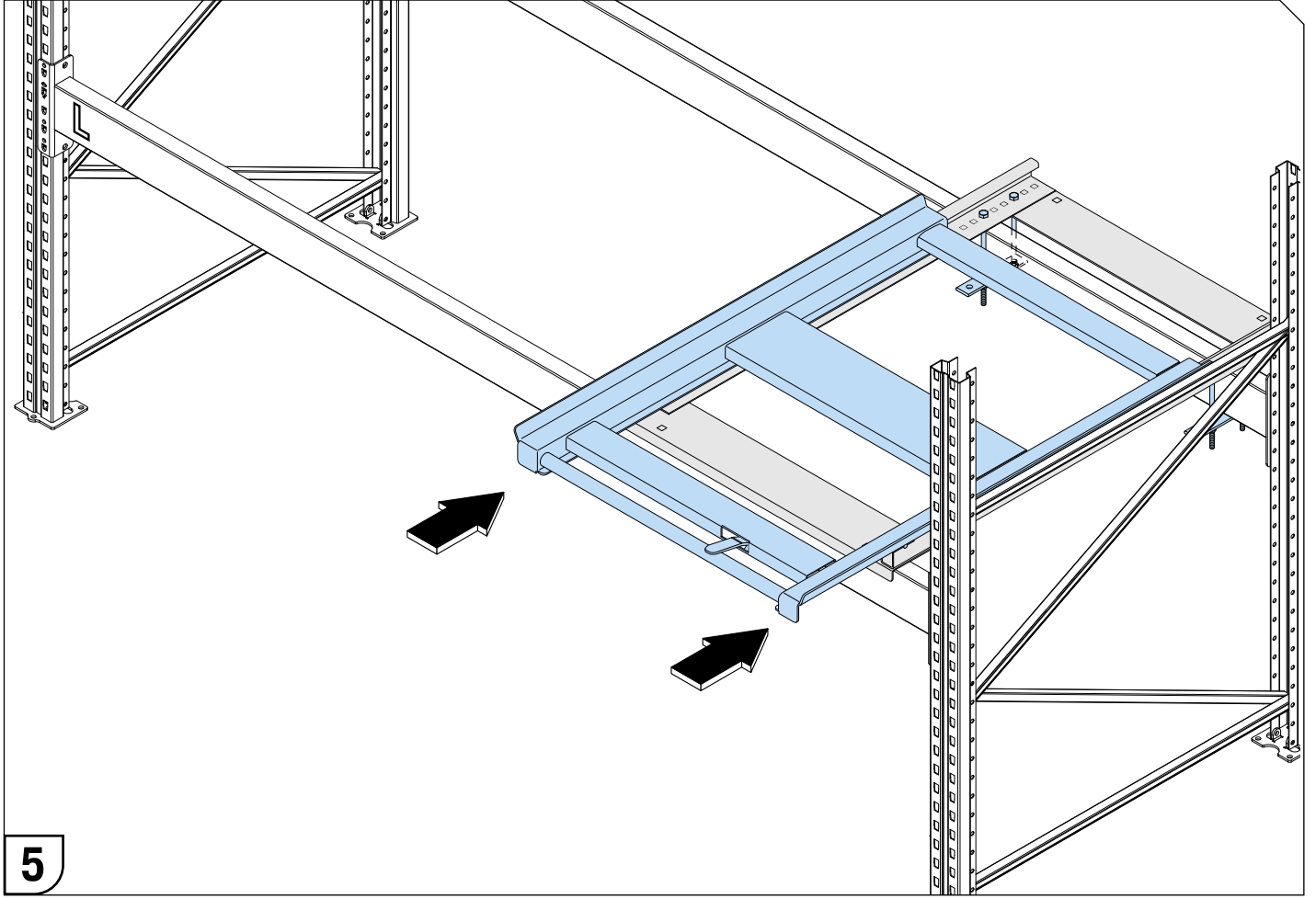

5

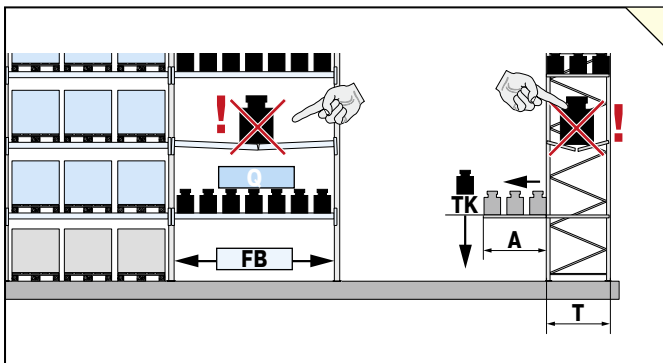

TK		Q (Fachlast/Level load)		
		FB = 950 mm	FB = 1800 mm	FB = 2700 mm
200 kg	A = 70 % T	510 kg	737 kg	964 kg
200 kg	A = 100 % T	643 kg	886 kg	1129 kg
300 kg	A = 100 % T	960 kg	1320 kg	1680 kg
600 kg	A = 70 % T	1476 kg	2112 kg	2748 kg
600 kg	A = 100 % T	1868 kg	2536 kg	3204 kg
800 kg	A = 70 % T	1974 kg	2828 kg	3682 kg
1000 kg	A = 70 % T	2488 kg	3576 kg	4664 kg
1000 kg	A = 100 % T	3098 kg	4196 kg	5294 kg

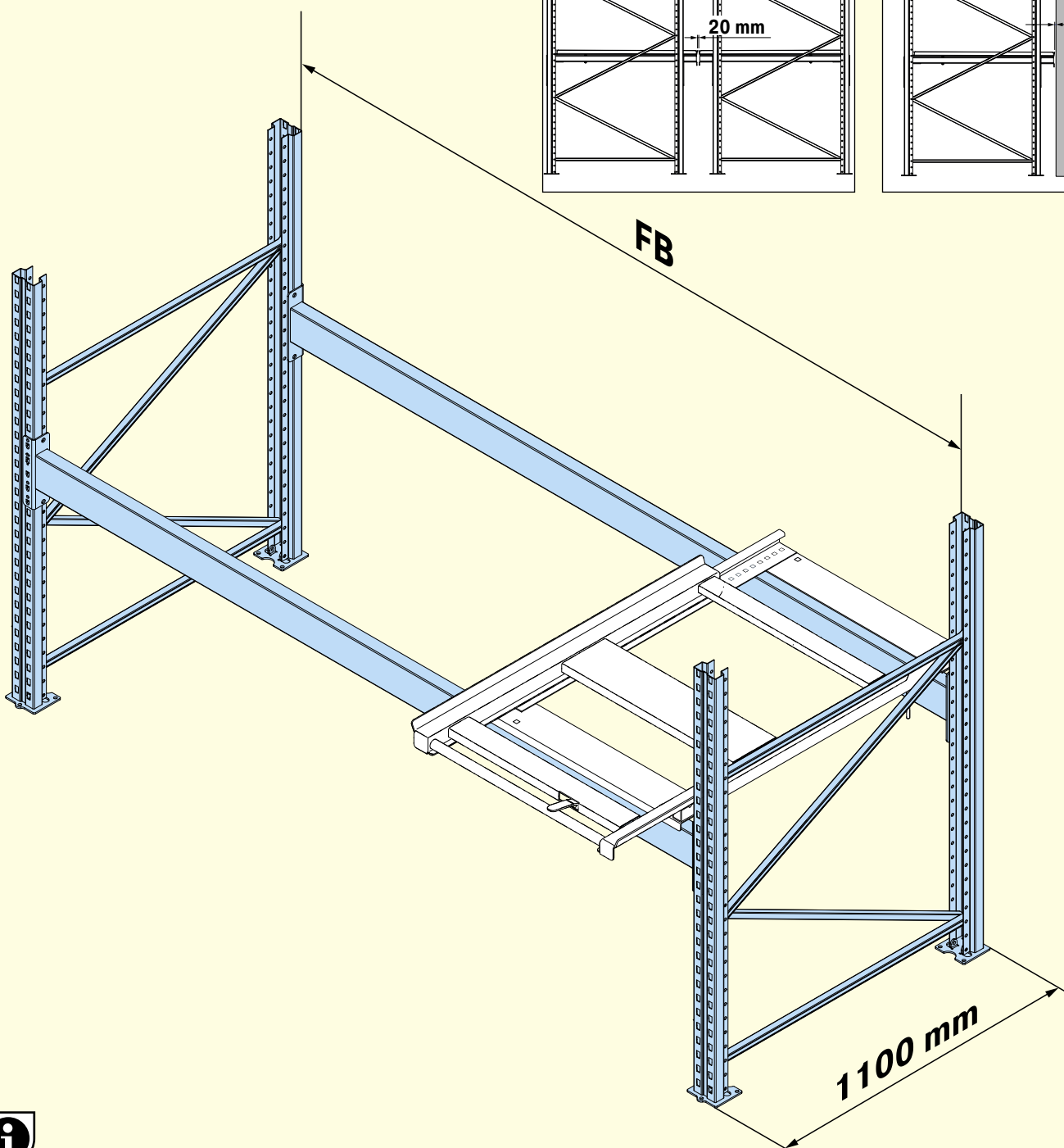
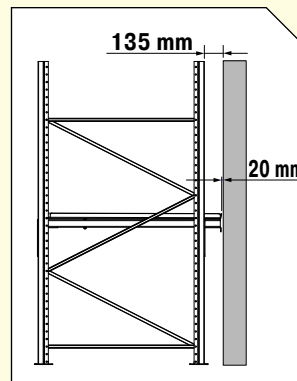
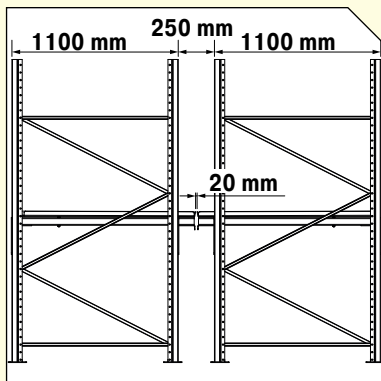

#6/2015/Art.-Nr.: 16454



Ihre Meinung!
Give your feedback!
feedbackmontage@bito.com

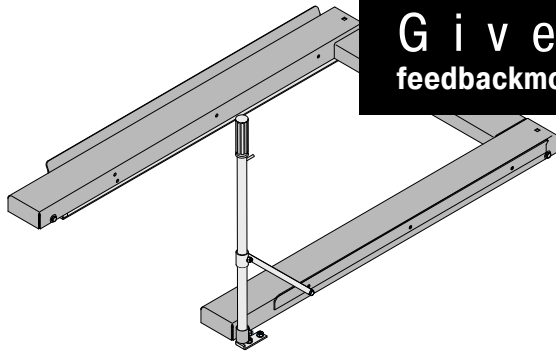

#33195 - 800 kg
#33196 - 1000 kg

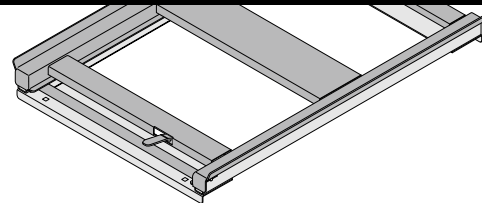

#33200 - 600 kg
#33201 - 800 kg

Ihre Meinung!
Give your feedback!
feedbackmontage@bito.com